

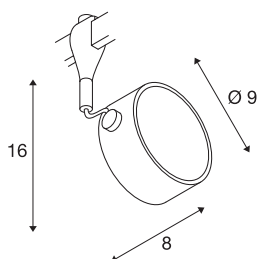

GX53 SPOT

spot for 240V track EASYTEC II, TCR-TSE, white, energy-saving lamp, max. 13W

GX53 SPOT swivelling and tiltable 240V floodlight with suitable adapter for the EASYTEC II track system. The luminaire is made of steel and, thanks to the built-in GX53 socket, is suitable for both energy-saving and LED lamps.



TECHNICAL DATA

Item no.	184741
Socket	GX53
Lamp	TCR-TSE
Number of sockets	1
Lamps included	No
Tilt range	180 °
Horizontal rotation range	350 °
Rotating or tilting	rotary Bar and tiltable
IP Code	IP 20
Assembly	Surface
Assembly details	Ceiling,Track Ceiling
Primary nominal voltage	220-240V ~50/60Hz
Safety class	I
Wattage	13 W
Color	white
Light outlet	direct
Length	8 cm
Height	16 cm
Diameter	9 cm
Net weight	0.297 kg
Gross weight	0.392 kg

Recommended lamp

1005271	LED GX53 , white / milky light, 6W 3000K CRI94 120°
1005269	LED GX53 , white / milky LED light, 6W 4000K CRI-90 120°
1005272	LED GX53 , white / milky light, 6W 2700K CRI90 120°