

1007945	200V-240V ~ 50/60Hz	6,2W	430 lm	3000K	CRI>90	18 x 39,3 x 16 cm	1,40 kg
1007946			360 lm				
1007947			430 lm			18 x 124,3 x 16 cm	2,50 kg
1007948			360 lm				

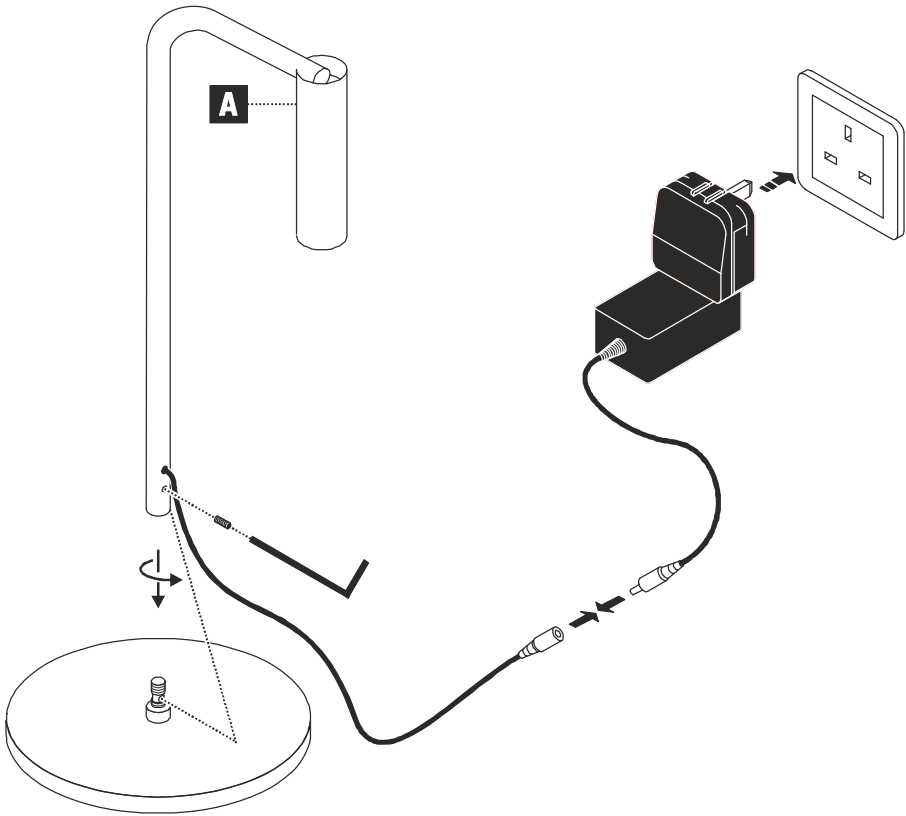

1007945
...46
...47
...48

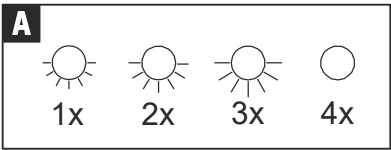

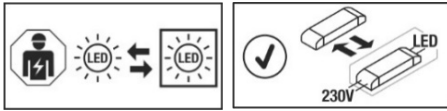

EN - The light source is only replaceable by a professional. The control gear is replaceable.

Technical Details are subject to change.

UK
CA

SLV UK
Unit E Chiltern Park
Boscombe Road, Bedfordshire
LU5 4LT

EN Operating Manual PART B

Table Lamp / Floor Lamp

1007945 ...46 ...47 ...48

Read manual carefully and keep for further use!

⚠ Safety advices for installation and operation.
Disregard may lead to danger of life, burning or fire!

Do not alter or modify the product.

Do not fasten anything on the product.

Do not cover the product.

Take out of service when suspecting a defect or malfunction and contact your dealer or a qualified electrician.

Take measures that children get not harmed by the product.

If the external flexible cable or cord of this luminaire is damaged, it shall be exclusively replaced by the manufacturer or a qualified electrician to avoid hazard.

Do not stare into the active light source.

Additional safety advices = ⚠

Use as directed

Safety class II (2)  - Safety insulated - Connection without protective conductor.

Operate only on an even, stable and tilt-fixed surface.

Operate only in dry indoor area.

Do not strain mechanically or expose to strong dirt contamination.

Light Source

The light source of this luminaire may only be replaced by the manufacturer, an authorized service technician or a comparable qualified person.

This product contains a light source of the energy efficiency class E.

Care / Storage

⚠ Disconnect product from mains and let it cool down.

Clean external surfaces regularly with a slightly moistened (water) cloth.

Store dry and clean.

Placement

Place in a way that product poses no danger(e.g. stumbling).

Putting into service

Connect mains plug with mains plug socket.

Using the push-button (A) the luminaire is switched on and the brightness may be adjusted in three steps.

⚠ Check for secure standing and proper function!