

ta: -20°C
...+45°C



220V - 240V ~50/60Hz

22W

2700K: 1200 lm
3000K: 1200 lm

CRI>90

233 x 232 cm

20,5 kg

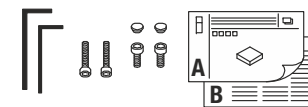

EN

INSTRUCTION MANUAL PART A
Floor lamp

1007961

1007962

1007963



1.

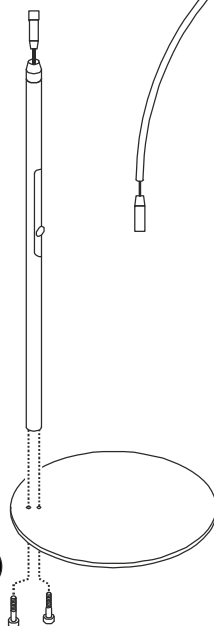

2.

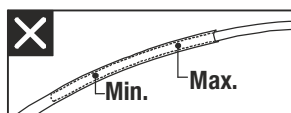
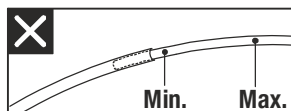
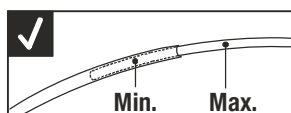

4.

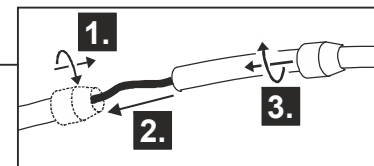
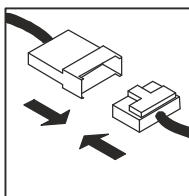

3.

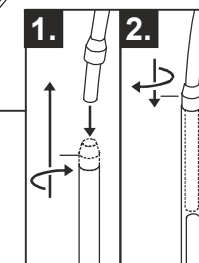
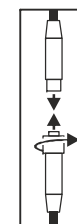

5.

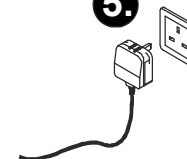



EN – The light source is only replaceable by a professional. The control gear is only replaceable by a professional.

Technical Details are subject to change.

UK SLV UK
CA Unit E Chiltern Park
 Boscombe Road, Bedfordshire
 LU5 4LT

EN Operating Manual PART B

Floor Stand Luminaire

1007961 ...62 ...63

Read manual carefully and keep for further use!

⚠ Safety advices for installation and operation.
Disregard may lead to danger of life, burning or fire!

Do not alter or modify the product.

Do not fasten anything on the product.

Do not cover the product.

Take out of service when suspecting a defect or malfunction and contact your dealer or a qualified electrician.

Take measures that children get not harmed by the product.

If the external flexible cable or cord of this luminaire is damaged, it shall be exclusively replaced by the manufacturer or a qualified electrician to avoid hazard.

Do not stare into the active light source.

Additional safety advices = ⚠

Use as directed

Safety class II (2)  - Safety insulated - Connection without protective conductor.

Operate only on an even, stable and tilt-fixed surface.

Operate only in dry indoor area.

Do not strain mechanically or expose to strong dirt contamination.

Admissible ambient temperature(ta): -20°C ...+45°C.

Light Source

The light source of this luminaire may only be replaced by the manufacturer, an authorized service technician or a comparable qualified person.

This product contains a light source of the energy efficiency class F.

Reference control setting: 3000K

Care / Storage

⚠ Disconnect product from mains and let it cool down.

Clean external surfaces regularly with a slightly moistened (water) cloth.

Store dry and clean.

Placement

Place in a way that product poses no danger(e.g. stumbling).

Putting into service

Connect mains plug with mains plug socket.

Operation

Switching-on: Press push-button shortly when luminaire is switched off.

Switching-off: Press push-button long.

Selection of adjustments: Press push-button shortly when luminaire is switched on.

Following adjustments are possible

Light color change

Selection of the lighting rings (top – bottom – both rings)

Brightness change

The luminaire has a storage function. The last settings are saved.

Turn the push-button to change the individual setting.

The light flashes when the minimum or maximum adjustment is reached.

⚠ Check for secure standing and proper function!