

Luminaire

[mm]

Blind Cover

[mm]

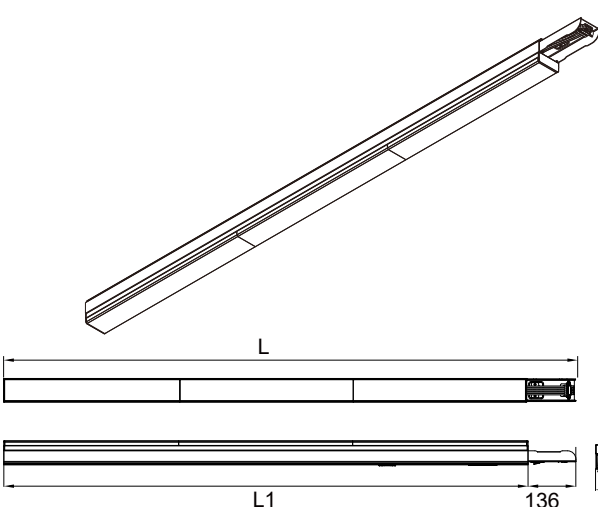

L	L1
1636	1500
2636	2500

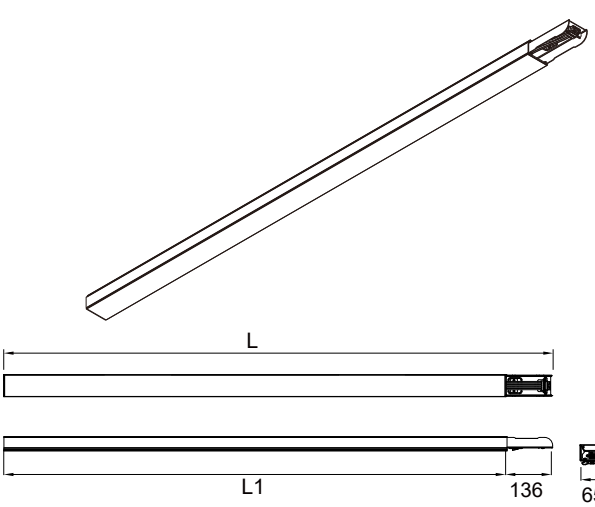

L	L1	Article No.
1636	1500	1009234, 1010552, 1009235, 1010553
2636	2500	1009236, 1010554, 1009237, 1010555
4636	4500	1009238, 1010556, 1009239, 1010557

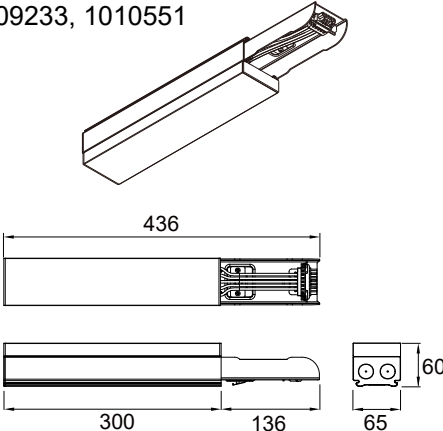
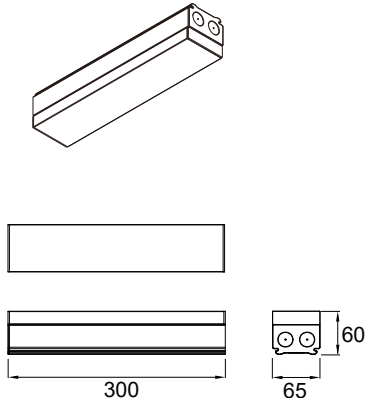
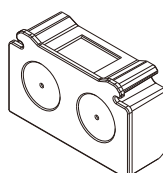
Accessories For AC Input And Output		[mm]
1009232, 1010550 1009233, 1010551 		
1009230, 1010548 1009231, 1010549 		
1009240 1010558 		

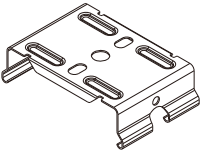
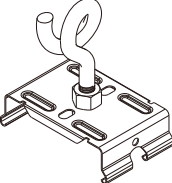
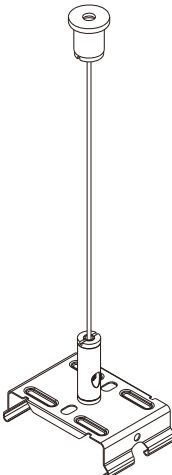
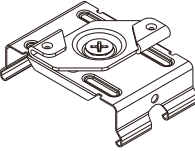
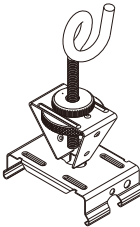
Mounting Accessories		
1009244, 1010563 1009245, 1010564  <p>Surface Ceiling Fixing</p>	1009241, 1010559  <p>Chain Suspension only Bracket</p>	1009243, 1010562 1009247, 1010561  <p>Steel Cable Suspension Kits</p>
1009246, 1010565  <p>Surface mounted butterfly hook</p>	1009242, 1010560  <p>Chain Suspension only Bracket (Fine tune)</p>	

## Installation Steps

### 1-a Surface Ceiling Fixing

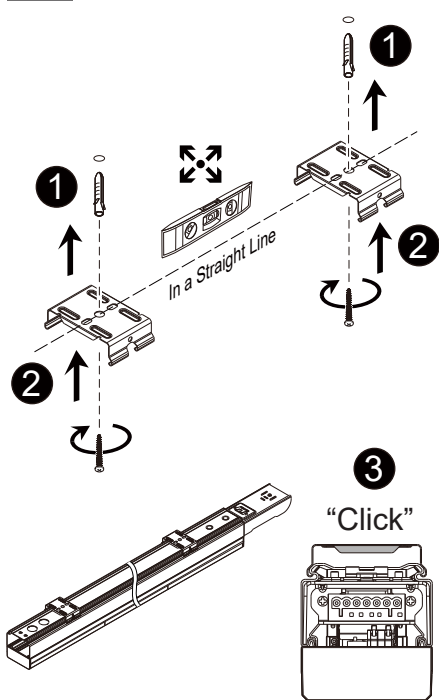

### 1-b Steel Cable Suspension Kits

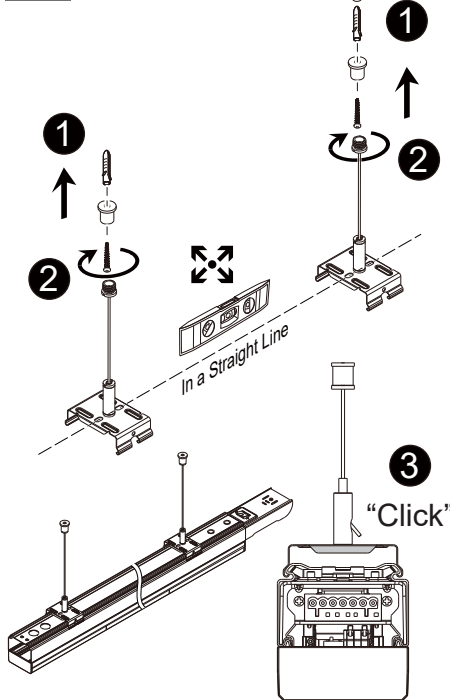

### 1-c Chain Suspension Kits

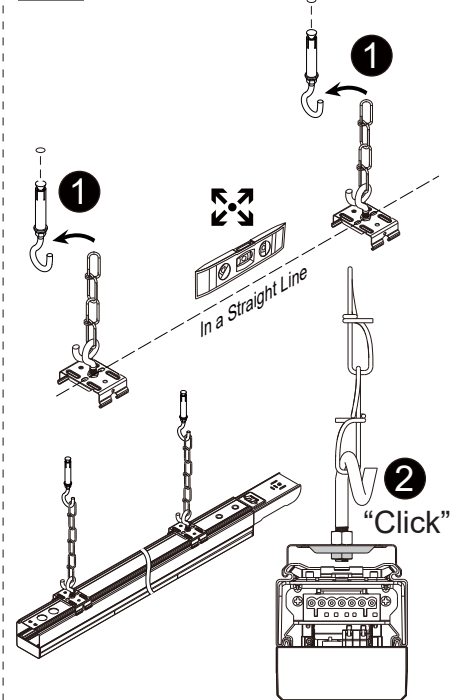

### 1-d Chain Suspension Kits

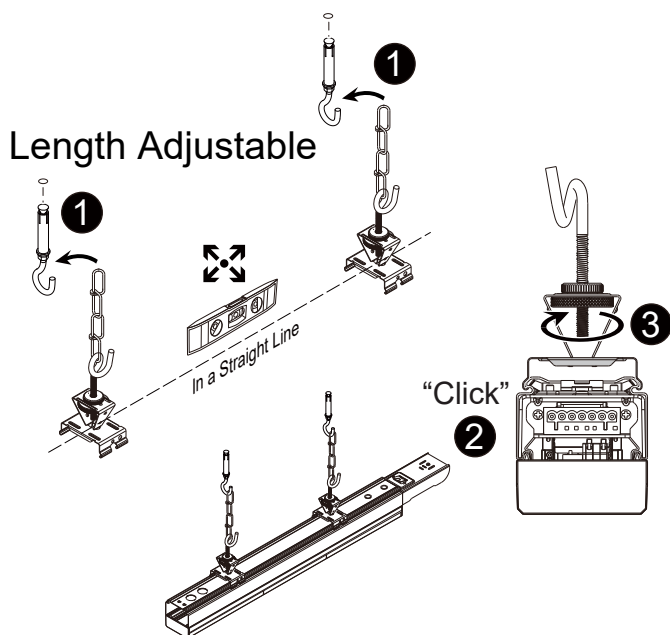

### 1-e Surface mounted butterfly hook

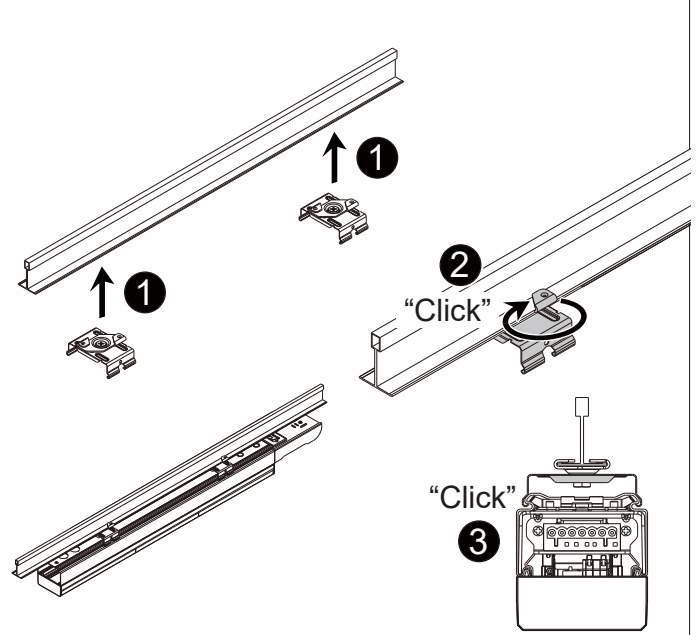

## Installation

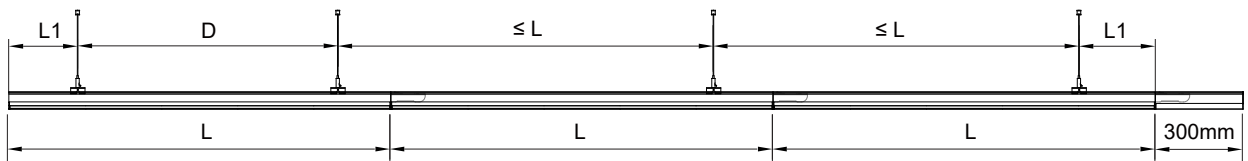

Luminaire Length ( L )	L1	D
1500mm	300-400mm	max 900mm
2000mm	500-600mm	max 1000mm
2500mm	500-600mm	max 1500mm
3000mm	500-700mm	max 2000mm
4500mm	700-800mm	max 3000mm

## Installation Steps

### 2 Mounting Luminaire

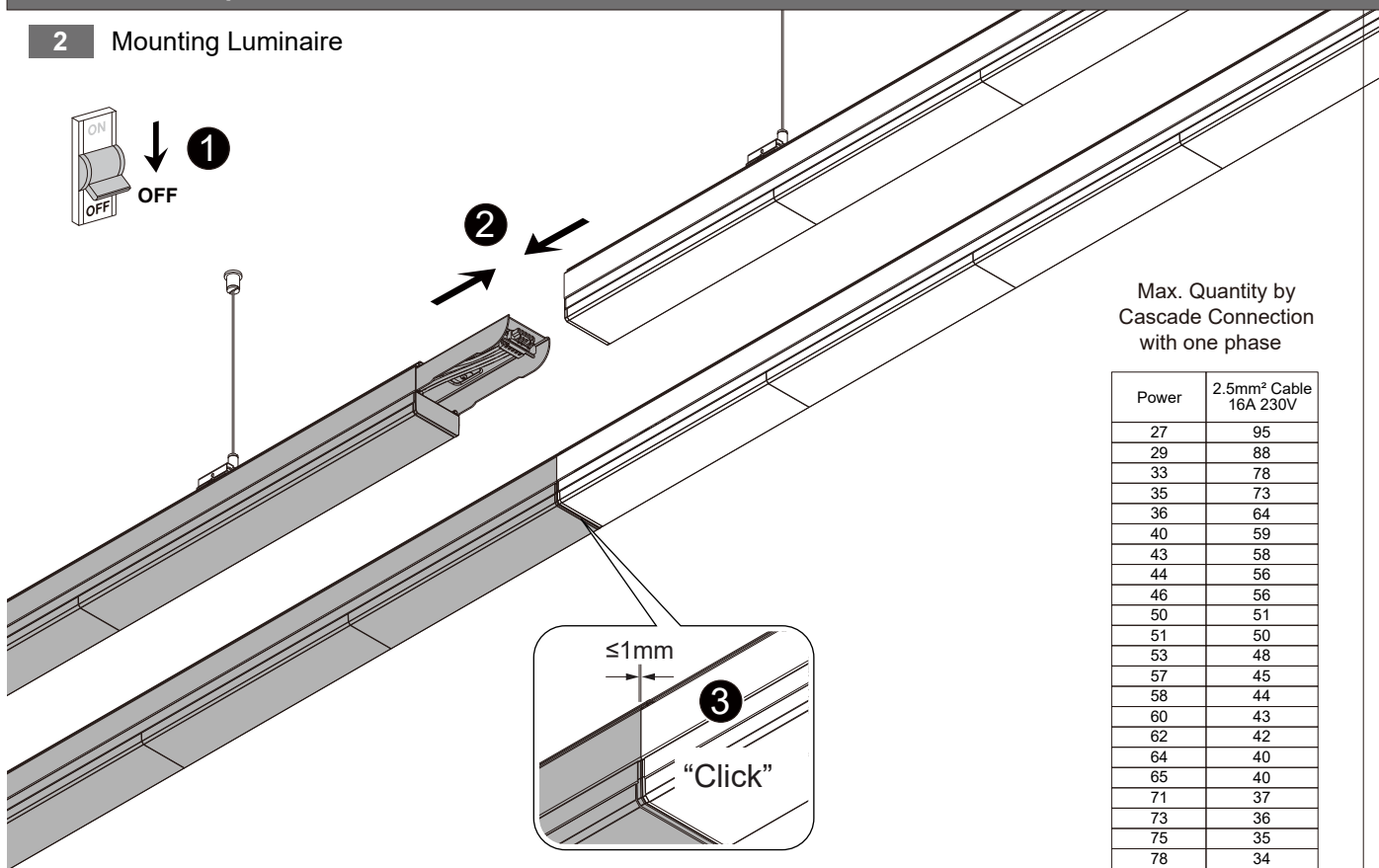
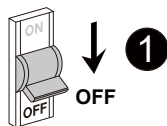

Max. Quantity by  
Cascade Connection  
with one phase

Power	2.5mm <sup>2</sup> Cable 16A 230V
27	95
29	88
33	78
35	73
36	64
40	59
43	58
44	56
46	56
50	51
51	50
53	48
57	45
58	44
60	43
62	42
64	40
65	40
71	37
73	36
75	35
78	34
80	33

### 3 Mounting Next (Option)

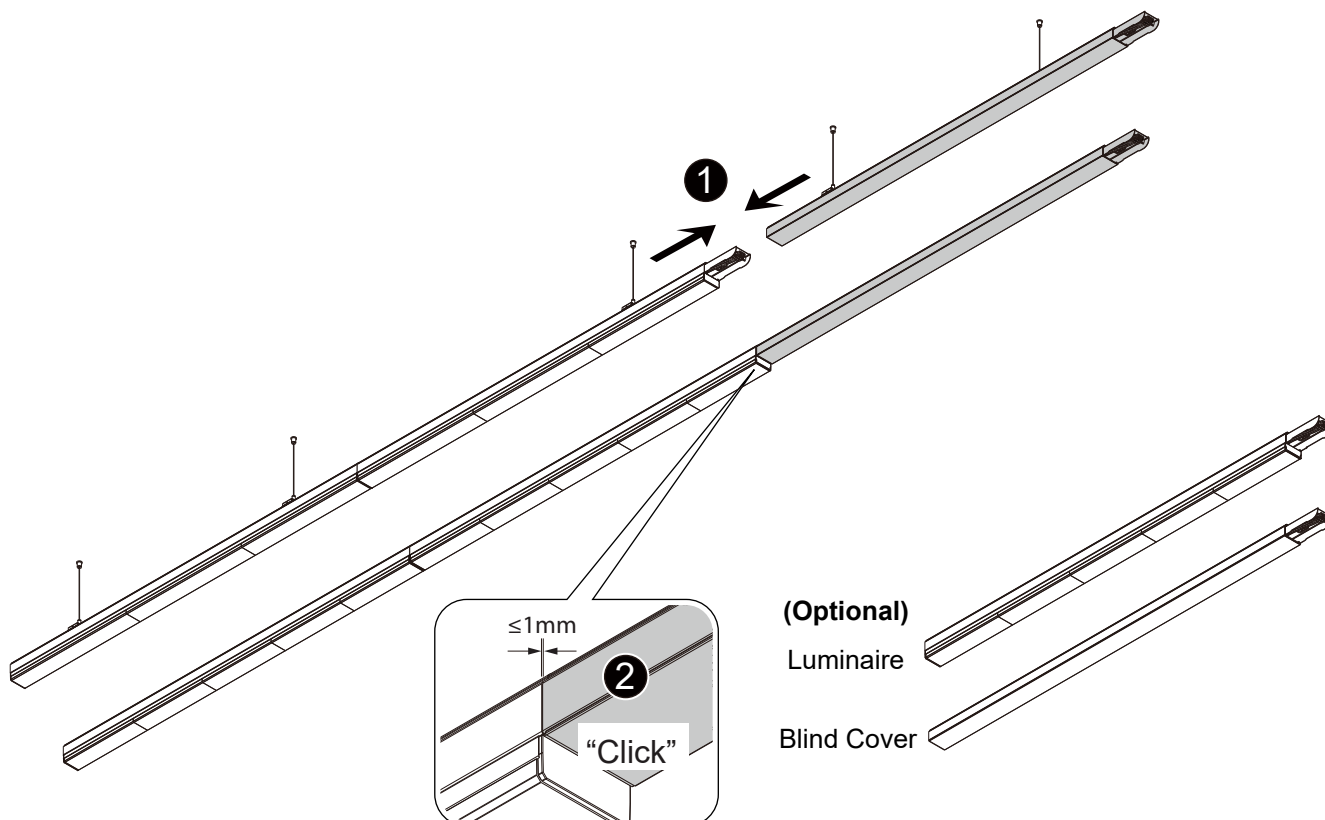



## Installation Steps

### 4-a Connecting Power Supply (Use the Feed In Box)

Connecting Wires from top or the side

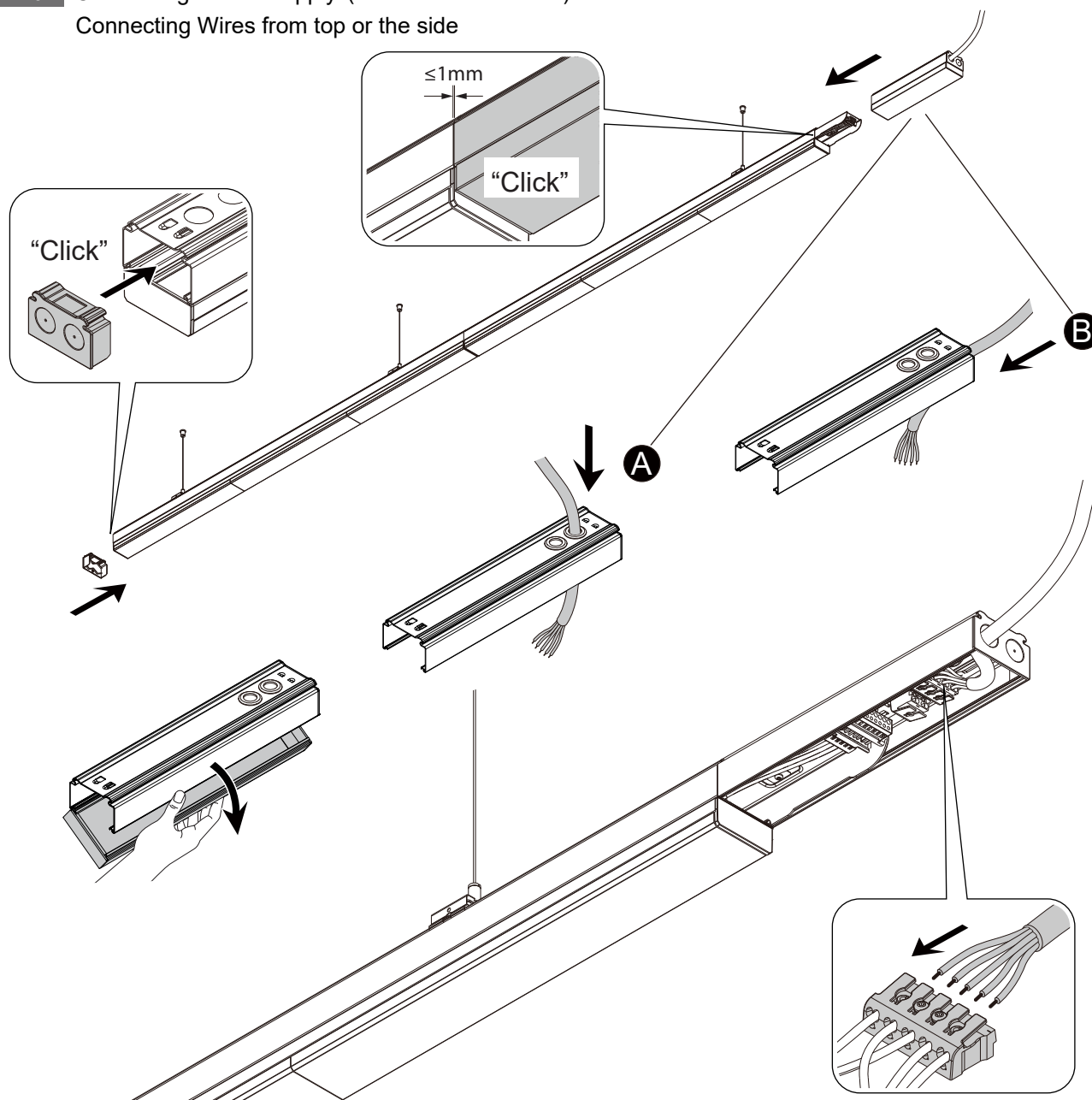

### 5 Wires specification:

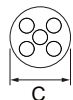

Outer diameter:  $\varnothing 8\text{mm} \leq C \leq 15\text{mm}$   
Core of cable:  $5 \times 2.5\text{mm}^2$

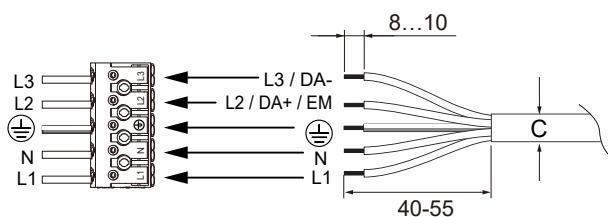

### 7 Wires specification:

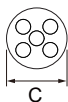

Outer diameter:  $\varnothing 8\text{mm} \leq C \leq 15\text{mm}$   
Core of cable:  $5 \times 2.5\text{mm}^2$

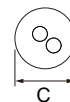

Outer diameter:  $\varnothing 8\text{mm} \leq C \leq 15\text{mm}$   
Core of cable:  $2 \times 2.5\text{mm}^2$

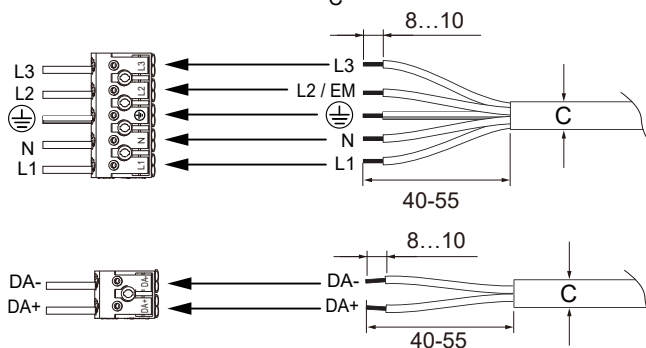

## Installation Steps

### 4-b Connecting Power Supply (Use the Feed Out Box) Connecting Wires from top or the side

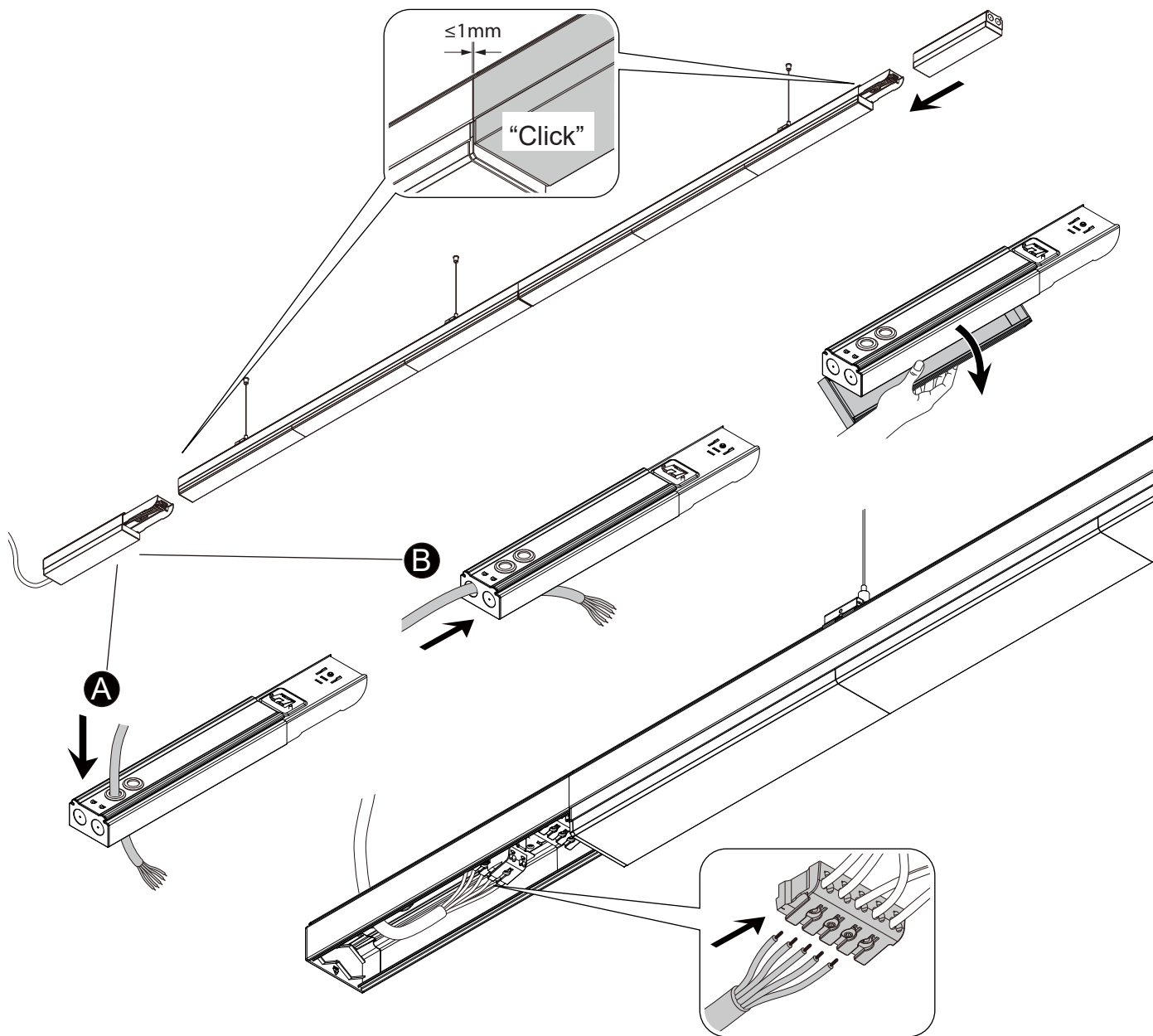

#### 5 Wires specification:

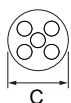

Outer diameter:  $\varnothing 8\text{mm} \leq C \leq 15\text{mm}$   
Core of cable:  $5 \times 2.5\text{mm}^2$

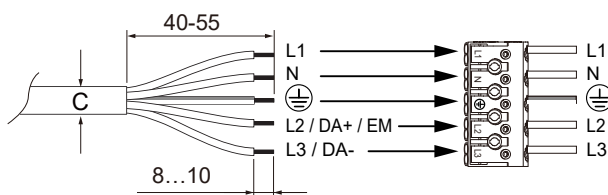

#### 7 Wires specification:

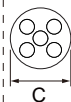

Outer diameter:  $\varnothing 8\text{mm} \leq C \leq 15\text{mm}$   
Core of cable:  $7 \times 2.5\text{mm}^2$

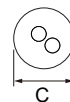

Outer diameter:  $\varnothing 8\text{mm} \leq C \leq 15\text{mm}$   
Core of cable:  $2 \times 2.5\text{mm}^2$

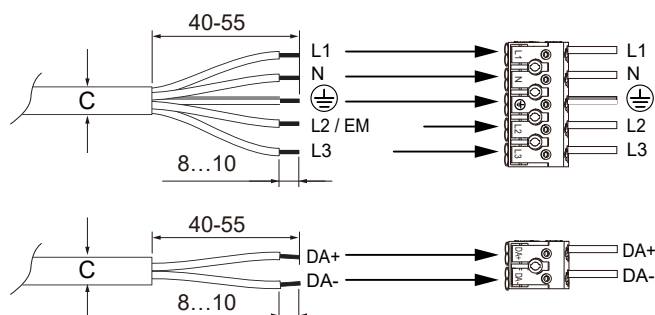

## Installation Steps

### 5 Wattage & CCT setting (Option)



ON OFF

Output current [mA]	Switch position (ON/OFF)			1009207, 1009208, 1009209, 1009210, 1009211, 1010525, 1010526, 1010527, 1010528, 1010529			1009217, 1009218, 1009219, 1009220, 1009221, 1010535, 1010536, 1010537, 1010538, 1010539		
	1	2	3	Power [W]	Light effect [lm/W]	Flux [lm]	Power [W]	Light effect [lm/W]	Flux [lm]
550	OFF	OFF	OFF	75	180	13500	80	189	15120
500	ON	OFF	OFF	68	182	12376	73	189	13797
450	OFF	ON	OFF	61	184	11224	65	190	12350
400	ON	ON	OFF	53	192	10152	58	191	11078
350	OFF	OFF	ON	46	189	8696	51	191.5	9767
300	ON	OFF	ON	40	189	7560	44	192.2	8457
250	OFF	ON	ON	33	190	6270	36	192.9	6944
200	ON	ON	ON	27	185	4992	29	193.6	5614



DALI

Output current [mA]	Switch position (ON/OFF)			1009212, 1009213, 1009214, 1009215, 1009216, 1010530, 1010531, 1010532, 1010533, 1010534			1009222, 1009223, 1009224, 1009225, 1009226, 1010540, 1010541, 1010542, 1010543, 1010544		
	1	2	3	Power [W]	Light effect [lm/W]	Flux [lm]	Power [W]	Light effect [lm/W]	Flux [lm]
550	ON	ON	ON	75	180	13500	80	189	15120
500	ON	ON	OFF	68	182	12376	73	189	13797
450	ON	OFF	ON	61	184	11224	65	190	12350
400	ON	OFF	OFF	53	192	10152	58	191	11078
350	OFF	ON	ON	46	189	8696	51	191.5	9767
300	OFF	ON	OFF	40	189	7560	44	192.2	8457
250	OFF	OFF	ON	33	190	6270	36	192.9	6944
200	OFF	OFF	OFF	27	185	4992	29	193.6	5614

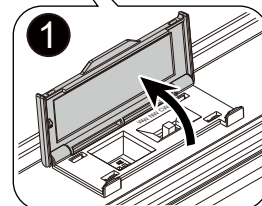
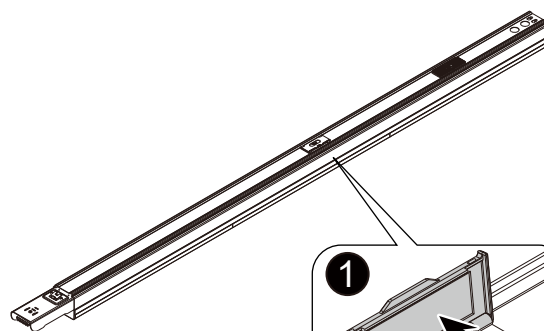

Wattage setting (Option)

CCT setting (Option)

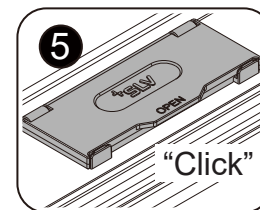
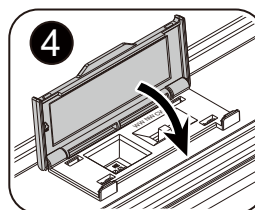
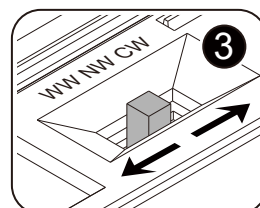
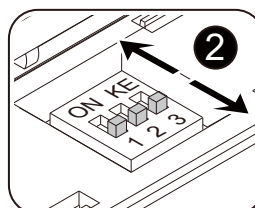

"Click"

### 6 Phase Change (factory settings is L2)

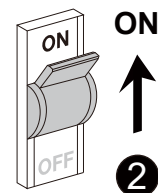
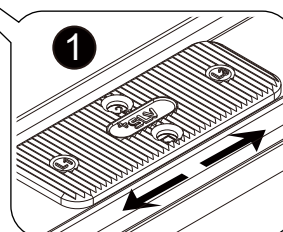

## Disassembly

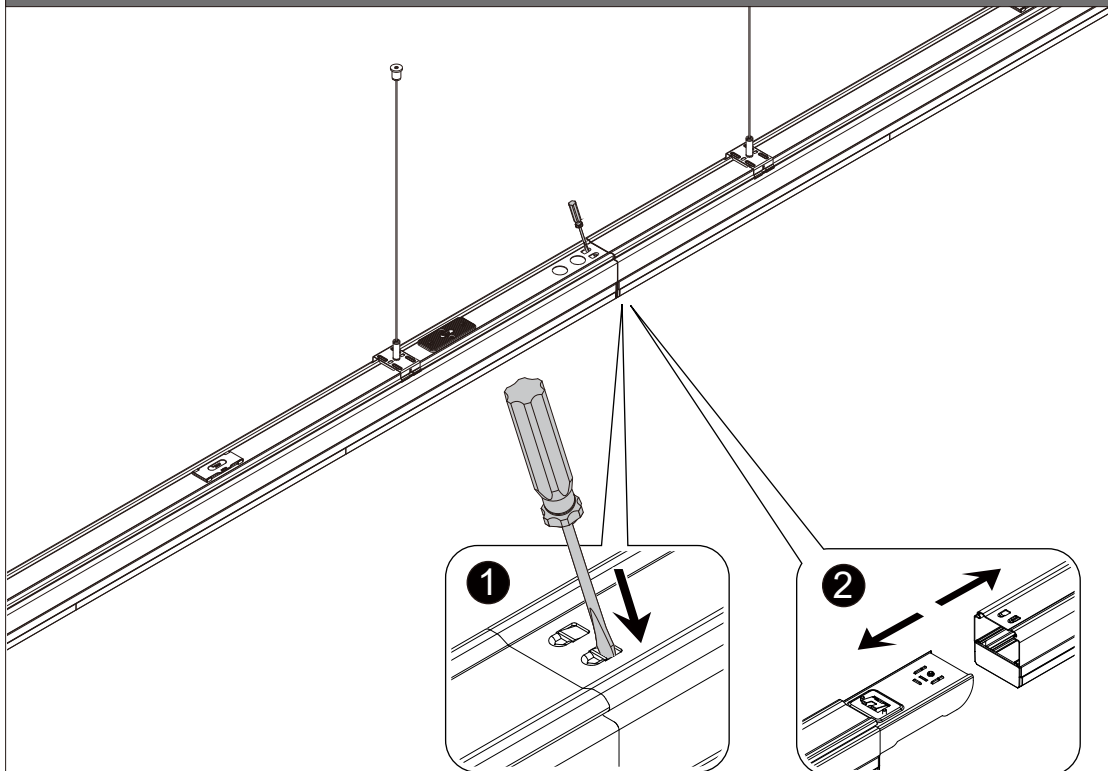

## IMPORTANT SAFETY NOTES

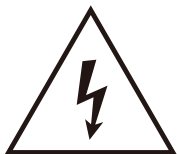

### **WARNING** RISK OF ELECTRIC SHOCK

#### **BEFORE YOU BEGIN**

- Read these instructions completely and carefully.
- The installation and connection of the luminaire must be done when switched off and by qualified people. Make sure no voltage while installation.

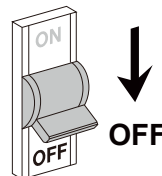

### **CAUTION**

#### **MAINTENANCE**

- To avoid injuries, disconnect power to the light and allow the unit to cool down before performing maintenance.
- Perform visual, mechanical and electrical inspections on a regular basis. We recommend routine checks to be made on an annual basis. Frequency of use and environment should determine this
- The Covers should be cleaned periodically as needed to ensure continued photometric performance. Clean the Cover with a damp, non-abrasive, lintfree cloth. If not sufficient, use mild soap or a liquid cleaner. Do not use an abrasive, strong alkaline or acid cleaner as damage may occur.
- Inspect the topside on the luminaire to ensure that it is free of any obstructions or contamination (i.e. excessive dust build-up). Clean with a non-abrasive cloth if needed.

**B**

This product contains a light source of energy efficiency class B.