

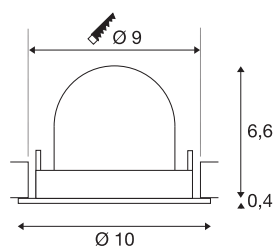

## NUMINOS® GIMBLE S

Recessed ceiling light, 3000 K, 20°, IP20, round, black

The NUMINOS light system from SLV combines technology, design and functionality like no other. With a variety of downlights and spotlights, you provide a thousand lighting design options. Like with the NUMINOS® GIMBLE S recessed ceiling light, which impresses with its high-quality workmanship and light. Ideal for harmonious, modern and space-saving lighting that directs the accent to objects or the room. Installation is then done in no time at all. When do you choose NUMINOS ® from SLV?



## TECHNICAL DATA

Item no.	1009397
Number of different light outlets	1
Rotating or tilting	rotary bar and tiltable
IP Code	IP20
Assembly	Recessed
Assembly details	Ceiling
Secondary power / voltage	200 mA
Safety class	III
Wattage	6.7 W
Minimum ambient temperature	-20 °C
Maximum ambient temperature	40 °C
Lumen	1050 lm
Colour temperature	3000 Kelvin
Beam angle	20 °
Color	black
CRI	90
UGR ≤	19
Service life	50000 h
Risk Group	1
Height	7 cm
Diameter	10 cm
Net weight	0.188 kg

## Light Source

2093839	
---------	---

### Accessories

1010681	NUMINOS® S , frosted diffuser
1010682	NUMINOS® S , Elliptical diffuser
1006139	Numinos® S Reducing ring , round 160/90 mm black
1010679	NUMINOS® S , Honeycomb diffuser
1010695	LED driver , 21W, 200 mA, DALI
1010703	LED driver , 23W, 200 mA, DALI
1010699	LED driver , 10W, 200 mA, PHASE
1006140	Numinos® S Reducing ring , round 160/90 mm white
1006142	Numinos® S Reducing ring , square 160/90 mm white
1010680	NUMINOS® S , Prismatic diffuser
1006141	Numinos® S Reducing ring , square 160/90 mm black
1010128	NUMINOS® S , reflector, copper
1010127	NUMINOS® S , reflector, gold

Gross weight	0.288 kg
Shape of cut-out	round
Installation depth	7 cm
Installation diameter	9 cm
BIG WHITE Page	47