

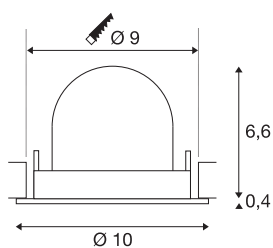

## NUMINOS® GIMBLE S

Recessed ceiling light, 4000 K, 40°, IP20, round, black / white

The NUMINOS light system from SLV skilfully combines function, design and technology. With various downlights and spotlights, you can experience a thousand lighting design possibilities. Also with the NUMINOS® GIMBLE S recessed ceiling light, which convinces with the best workmanship and lighting quality. Ideal for discreet, modern and space-saving lighting that directs the accent to objects or the room. Installation is then done in no time at all. When do you choose NUMINOS ® from SLV?



## TECHNICAL DATA

|                                   |                         |
|-----------------------------------|-------------------------|
| Item no.                          | 1009419                 |
| Number of different light outlets | 1                       |
| Rotating or tilting               | rotary bar and tiltable |
| IP Code                           | IP20                    |
| Assembly                          | Recessed                |
| Assembly details                  | Ceiling                 |
| Secondary power / voltage         | 200 mA                  |
| Safety class                      | III                     |
| Wattage                           | 6.7 W                   |
| Minimum ambient temperature       | -20 °C                  |
| Maximum ambient temperature       | 40 °C                   |
| Lumen                             | 1050 lm                 |
| Colour temperature                | 4000 Kelvin             |
| Beam angle                        | 40 °                    |
| Color                             | black/white             |
| CRI                               | 90                      |
| UGR ≤                             | 19                      |
| Service life                      | 50000 h                 |
| Risk Group                        | 1                       |
| Height                            | 7 cm                    |
| Diameter                          | 10 cm                   |
| Net weight                        | 0.188 kg                |

## Light Source

|         |   |
|---------|---|
| 2093742 |  |
|---------|---|

### Accessories

|         |   |
|---------|---|
| 1010681 | NUMINOS® S , frosted diffuser                     |
| 1010682 | NUMINOS® S , Elliptical diffuser                  |
| 1006139 | Numinos® S Reducing ring , round 160/90 mm black  |
| 1010679 | NUMINOS® S , Honeycomb diffuser                   |
| 1010695 | LED driver , 21W, 200 mA, DALI                    |
| 1010703 | LED driver , 23W, 200 mA, DALI                    |
| 1010699 | LED driver , 10W, 200 mA, PHASE                   |
| 1006140 | Numinos® S Reducing ring , round 160/90 mm white  |
| 1006142 | Numinos® S Reducing ring , square 160/90 mm white |
| 1010680 | NUMINOS® S , Prismatic diffuser                   |
| 1006141 | Numinos® S Reducing ring , square 160/90 mm black |
| 1010128 | NUMINOS® S , reflector, copper                    |
| 1010127 | NUMINOS® S , reflector, gold                      |

|                       |          |
|-----------------------|----------|
| Gross weight          | 0.288 kg |
| Shape of cut-out      | round    |
| Installation depth    | 7 cm     |
| Installation diameter | 9 cm     |