

NUMINOS® GIMBLE M

Recessed ceiling light, 2700 K, 20°, white

NUMINOS is the perfectly coordinated light system from SLV that combines function, design and technology. The diverse downlights and spotlights make a thousand lighting design options possible. This also includes NUMINOS® GIMBLE M, which impresses as a recessed ceiling light with the best workmanship and lighting quality. In this way, you can create unobtrusive, modern and space-saving lighting that draws the focus to objects or the room. Installation is then done in no time at all. When will you choose SLV's modular variety?

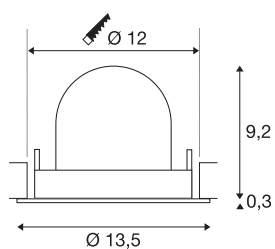

TECHNICAL DATA

Item no.	1009551
Number of different light outlets	1
Rotating or tilting	rotary bar and tiltable
IP Code	IP20
Assembly	Recessed
Assembly details	Ceiling
Secondary power / voltage	350 mA
Safety class	III
Wattage	12 W
Minimum ambient temperature	-20 °C
Maximum ambient temperature	40 °C
Lumen	1700 lm
Colour temperature	2700 Kelvin
Beam angle	20 °
Color	white
CRI	90
UGR ≤	19
Service life	50000 h
Risk Group	1
Height	9.5 cm
Diameter	13.5 cm
Net weight	0.41 kg

Light Source

2093870	
---------	---

Accessories

1010704	LED driver , 23W, 350 mA, DALI
1006143	Numinos® M Reducing ring , round 240/120 mm black
1010700	LED driver , 20W, 350 mA, PHASE
1010683	NUMINOS® M , Honey-comb diffuser
1006146	Numinos® M Reducing ring , square 240/120 mm white
1006144	Numinos® M Reducing ring , round 240/120 mm white
1010686	NUMINOS® M , Elliptical diffuser
1010684	NUMINOS® M , Prismatic diffuser
1006145	Numinos® M Reducing ring , square 240/120 mm black
1010696	LED driver , 21W, 350 mA
1010685	NUMINOS® M , frosted diffuser
1010129	NUMINOS® M , reflector, gold
1010130	NUMINOS® M , reflector, copper

Gross weight	0.56 kg
Shape of cut-out	round
Installation depth	9.5 cm
Installation diameter	12 cm
BIG WHITE Page	49