

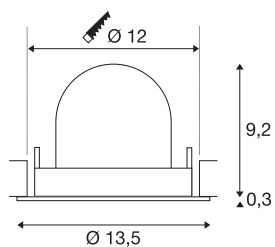

NUMINOS® GIMBLE M

Recessed ceiling light, 2700 K, 55°, white

NUMINOS is the perfectly coordinated light system from SLV that combines function, design and technology. With various downlights and spotlights, you provide a thousand lighting design options. This also includes NUMINOS® GIMBLE M, which impresses as a recessed ceiling light with the best workmanship and lighting quality. In this way, you can create discreet, modern and space-saving lighting that draws the focus to objects or the room. This means that easy installation is a mere formality. When do you choose NUMINOS ® from SLV?



TECHNICAL DATA

| | |
|-----------------------------------|-------------------------|
| Item no. | 1009557 |
| Number of different light outlets | 1 |
| Rotating or tilting | rotary bar and tiltable |
| IP Code | IP20 |
| Assembly | Recessed |
| Assembly details | Ceiling |
| Secondary power / voltage | 350 mA |
| Safety class | III |
| Wattage | 12 W |
| Minimum ambient temperature | -20 °C |
| Maximum ambient temperature | 40 °C |
| Lumen | 1700 lm |
| Colour temperature | 2700 Kelvin |
| Beam angle | 55 ° |
| Color | white |
| CRI | 90 |
| UGR ≤ | 22 |
| Service life | 50000 h |
| Risk Group | 1 |
| Height | 9.5 cm |
| Diameter | 13.5 cm |
| Net weight | 0.41 kg |

Light Source

| | |
|---------|---|
| 2093870 |  |
|---------|---|

Accessories

| | |
|---------|--|
| 1010704 | LED driver , 23W, 350 mA, DALI |
| 1006143 | Numinos® M Reducing ring , round 240/120 mm black |
| 1010700 | LED driver , 20W, 350 mA, PHASE |
| 1010683 | NUMINOS® M , Honeycomb diffuser |
| 1006146 | Numinos® M Reducing ring , square 240/120 mm white |
| 1006144 | Numinos® M Reducing ring , round 240/120 mm white |
| 1010686 | NUMINOS® M , Elliptical diffuser |
| 1010684 | NUMINOS® M , Prismatic diffuser |
| 1006145 | Numinos® M Reducing ring , square 240/120 mm black |
| 1010696 | LED driver , 21W, 350 mA |
| 1010685 | NUMINOS® M , frosted diffuser |
| 1010129 | NUMINOS® M , reflector, gold |
| 1010130 | NUMINOS® M , reflector, copper |

| | |
|-----------------------|---------|
| Gross weight | 0.56 kg |
| Shape of cut-out | round |
| Installation depth | 9.5 cm |
| Installation diameter | 12 cm |
| BIG WHITE Page | 49 |