

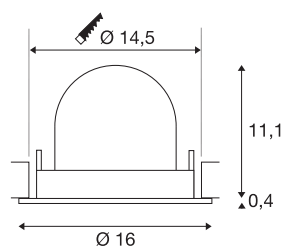

NUMINOS® GIMBLE L

Recessed ceiling light, 3000 K, 40°, IP20, round, black

NUMINOS is the best possible coordinated light system from SLV that combines function, design and technology. The various downlights and spotlights make a thousand lighting design options possible. Also with the NUMINOS® GIMBLE L recessed ceiling light, which convinces with the best workmanship and lighting quality. Ideal for unobtrusive, modern and space-saving lighting that draws the focus to objects or the room. Installation is then done in no time at all. When do you choose NUMINOS ® from SLV?



TECHNICAL DATA

Item no.	1009724
Number of different light outlets	1
Rotating or tilting	rotary bar and tiltable
IP Code	IP20
Assembly	Recessed
Assembly details	Ceiling
Secondary power / voltage	500 mA
Safety class	III
Wattage	17 W
Minimum ambient temperature	-20 °C
Maximum ambient temperature	40 °C
Lumen	2500 lm
Colour temperature	3000 Kelvin
Beam angle	40 °
Color	black
CRI	90
UGR ≤	22
Service life	50000 h
Risk Group	1
Height	11.5 cm
Diameter	16 cm
Net weight	0.606 kg

Light Source

2093856	
---------	---

Accessories

1006148	Numinos® L Reducing ring , round 240/150 mm white
1006149	Numinos® L Reducing ring , square 240/150 mm black
1010689	NUMINOS® L , Frosted diffuser
1010697	LED driver , 21W, 500 mA
1010687	NUMINOS® L , Honeycomb diffuser
1010701	LED driver , 19 W, 500 mA, PHASE
1010688	NUMINOS® L , Prismatic diffuser
1006150	Numinos® L Reducing ring , square 240/150 mm white
1006147	Numinos® L Reducing ring , round 240/150 mm black
1010690	NUMINOS® L , Elliptical diffuser
1010705	LED driver , 36W, 500 mA, DALI
1010132	NUMINOS® L , reflector, copper
1010131	NUMINOS® L , reflector, gold

Gross weight	0.756 kg
Shape of cut-out	round
Installation depth	11.5 cm
Installation diameter	14.5 cm
BIG WHITE Page	51