

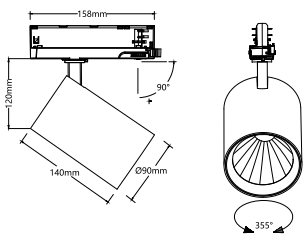

## TRACKSPOT

### P90 3PH. 56 930 MB ML WH

The TRACKSPOT P90 series features a clear, timeless design, an integrated driver and an impressive efficiency of up to 170 lm/W. With a color reproduction of CRI>90 and a choice of light colours (3,000 K / 4,000 K), it provides excellent illumination in demanding lighting situations - from shops and supermarkets to reception areas. Three beam angles are available (36°, 47° or 60°) and two body sizes ensure maximum adaptability to different room heights and lighting requirements. Symmetrical light distribution and a UGR of <25 also provide comfortable glare-free lighting. TRACKSPOT P90 is available in black and white and is supplied with a long-life LED module (L80B10, 50,000 h). The robust housing with protection class IP20 and impact resistance IK03 makes it the ideal solution for professional indoor use.



## TECHNICAL DATA

Item no.	1010596
Number of different light outlets	1
IP Code	IP20
Impact resistance class	IK 03
Assembly details	Ceiling,Wall
Primary nominal voltage	220-240V ~50/60 Hz
Secondary power / voltage	850-1000 mA
Safety class	II
Wattage	24 W
Minimum ambient temperature	-20 °C
Maximum ambient temperature	40 °C
Lumen	4960 / 5750 lm
Colour temperature	3000 Kelvin
Beam angle	36 °
Color	white
CRI	90
UGR ≤	25
Service life	50000 h
Length	17.3 cm
Height	14 cm
Diameter	9 cm
Net weight	0.81 kg

## Light Source

2194030



Gross weight

0.95 kg