

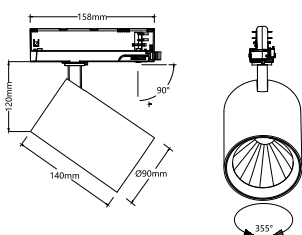

TRACKSPOT

P90 3PH. 57 940 MB ML BK

The TRACKSPOT P90 series features a clear, timeless design, an integrated driver and an impressive efficiency of up to 170 lm/W. With a color reproduction of CRI>90 and a choice of light colours (3,000 K / 4,000 K), it provides excellent illumination in demanding lighting situations - from shops and supermarkets to reception areas. Three beam angles are available (36°, 47° or 60°) and two body sizes ensure maximum adaptability to different room heights and lighting requirements. Symmetrical light distribution and a UGR of <25 also provide comfortable glare-free lighting. TRACKSPOT P90 is available in black and white and is supplied with a long-life LED module (L80B10, 50,000 h). The robust housing with protection class IP20 and impact resistance IK03 makes it the ideal solution for professional indoor use.



TECHNICAL DATA

| | |
|-----------------------------------|--------------------|
| Item no. | 1010597 |
| Number of different light outlets | 1 |
| IP Code | IP20 |
| Impact resistance class | IK 03 |
| Assembly details | Ceiling,Wall |
| Primary nominal voltage | 220-240V ~50/60 Hz |
| Secondary power / voltage | 850-1000 mA |
| Safety class | II |
| Wattage | 24 W |
| Minimum ambient temperature | -20 °C |
| Maximum ambient temperature | 40 °C |
| Lumen | 5250 / 6100 lm |
| Colour temperature | 4000 Kelvin |
| Beam angle | 36 ° |
| Color | black |
| CRI | 90 |
| UGR ≤ | 25 |
| Service life | 50000 h |
| Length | 17.3 cm |
| Height | 14 cm |
| Diameter | 9 cm |
| Net weight | 0.81 kg |

Light Source

2194037



Gross weight

0.95 kg