

IMPORTANT SAFETY NOTES



WARNING RISK OF ELECTRIC SHOCK

BEFORE YOU BEGIN

- Read these instructions completely and carefully.
- The installation and connection of the luminaire must be done when switched off and by qualified people. Make sure no voltage while installation.

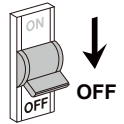

CAUTION

MAINTENANCE

- To avoid injuries, disconnect power to the light and allow the unit to cool down before performing maintenance.
- Perform visual, mechanical and electrical inspections on a regular basis. We recommend routine checks to be made on an annual basis. Frequency of use and environment should determine this.
- The Covers should be cleaned periodically as needed to ensure continued photometric performance. Clean the Cover with a damp, non-abrasive, lintfree cloth. If not sufficient, use mild soap or a liquid cleaner. Do not use an abrasive, strong alkaline or acid cleaner as damage may occur.
- Inspect the topside on the luminaire to ensure that it is free of any obstructions or contamination (i.e. excessive dust build-up). Clean with a non-abrasive cloth if needed.







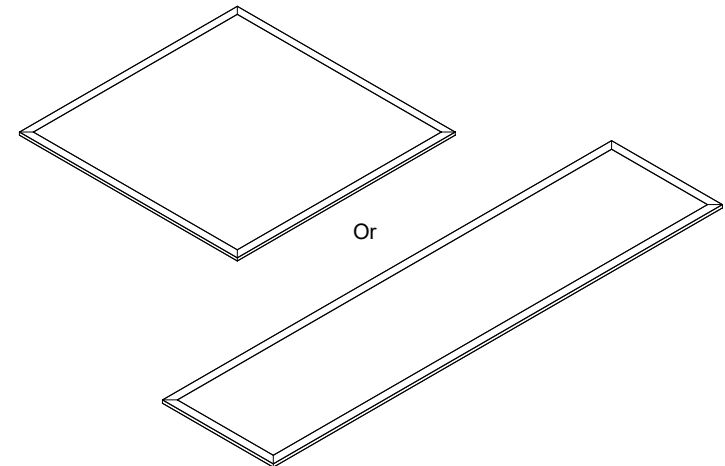

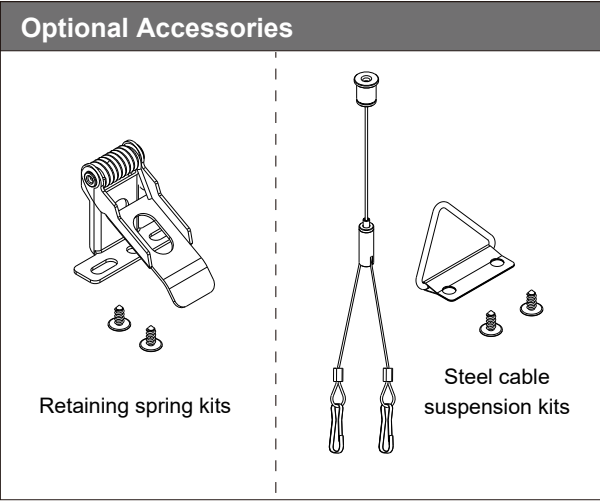
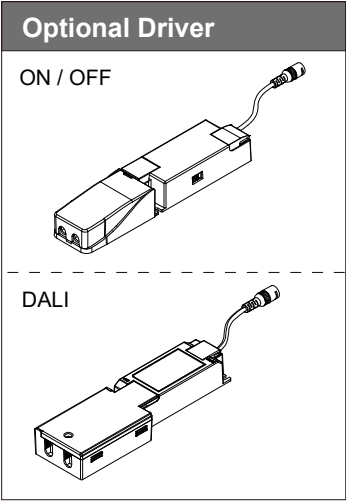
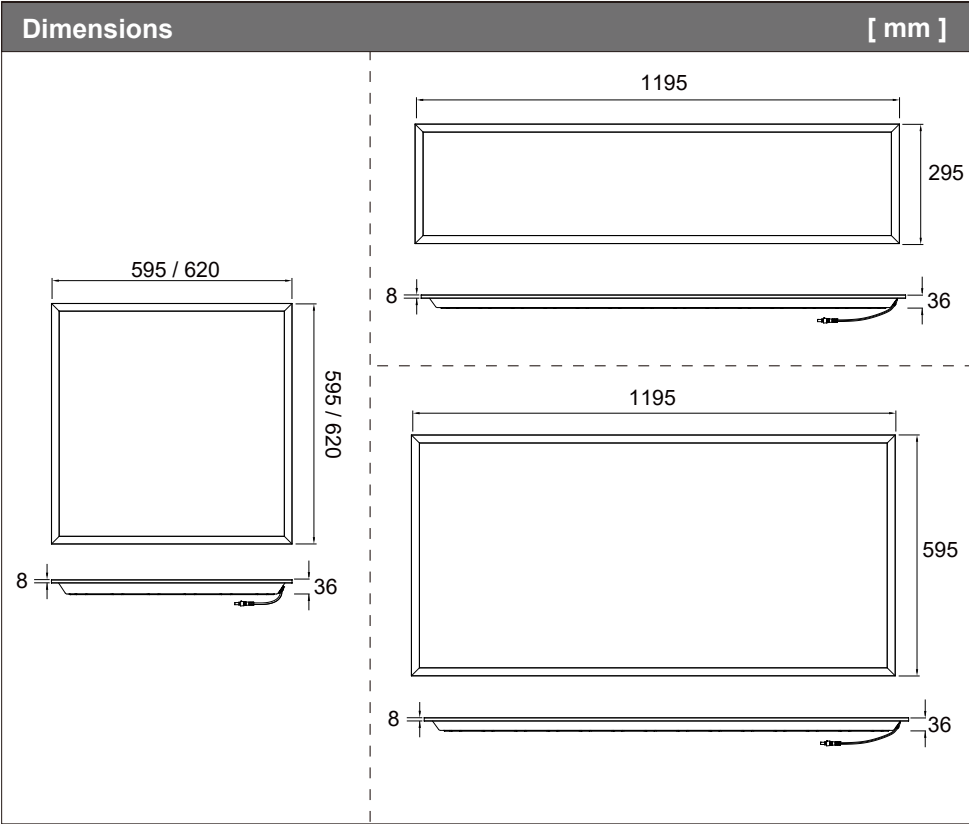
- Luminaires not suitable for covering with thermally insulating material

Products



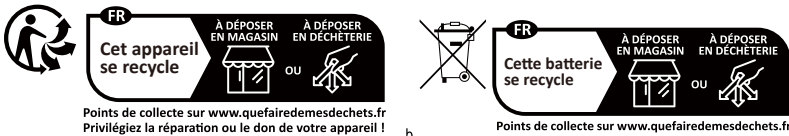

	<p>DA - Henvísning om bortskafning (EU) Produktet må ikke bortskaffes sammen med husholdningsaffaldet! Produkter med dette symbol skal i henhold til direktivet (WEEE) om affald af elektrisk og elektronisk udstyr bortskaffes via de lokale indsamlingssteder for gamle el-apparater! Gamle batterier og gamle akkumulatorer, der ikke er fast indbygget i det gamle apparat, og pærer, som uden at blive beskadiget kan tages ud af det gamle apparat, skal før aflevering på en genbrugsstation fjernes fra det gamle apparat uden beskadigelser. Distributører er i henhold til de gældende lovskræve bestemmelser forpligtet til at tage imod gamle apparater fra en slutbruger. Det gamle apparat kan også sendes til følgende adresse til bortskaffelse i Tyskland: SLV GmbH, Technischer Service, Werkstrasse 8-10, 52531 Übach-Palenberg, Tyskland</p>
	<p>PL - Wskazówka dotycząca utylizacji (Unia Europejska) Nie wolno wyrzucać produktu do śmieci domowych! Produkty oznakowane tym symbolem należy utylizować zgodnie z wytycznymi (WEEE) dotyczącymi starych urządzeń elektrycznych i elektronicznych w miejscowych punktach gromadzenia odpadów elektrycznych! Zużyte baterie i akumulatory, które nie są wbudowane w zużyte urządzenie, jak również lampy, które można wyjąć ze zużytego urządzenia w sposób nieniszczący, należy w sposób nieniszczący oddzielić od zużytego urządzenia przed przekazaniem go do punktu zbiórki. Zgodnie z obowiązującymi przepisami dystrybutorzy są zobowiązani do odbioru zużytych urządzeń od użytkownika końcowego. Zużyte urządzenie można również wysłać na poniższy adres w celu utylizacji na terenie Niemiec: SLV GmbH, Technischer Service, Werkstrasse 8-10, 52531 Übach-Palenberg, Niemcy</p>
	<p>RU - Указание по утилизации (Европейский Союз) Не утилизировать прибор вместе с бытовыми отходами! Продукты с подобным обозначением в соотв. с Положением (WEEE) по утилизации старых электрических и электронных приборов необходимо утилизировать через специальные пункты сбора старых электроприборов! Перед доставкой в пункт сбора необходимо отделить от старого устройства неразрушающим способом старые батареи и аккумуляторы, которые не заключены внутри старого устройства, а также лампы, которые можно извлечь из старого устройства неразрушающим способом. Согласно существующему законодательству дистрибьюторы обязаны принимать старые устройства от конечного пользователя. Старый прибор можно также отправить по следующему адресу для утилизации на территории Германии: SLV GmbH, Technischer Service, Werkstrasse 8-10, 52531 Übach-Palenberg, Германия</p>
	<p>SV - Anvisningar för sophantering (Europeiska Unionen) Produkten får ej kastas i hushållssoporna! Produkter som är märkta med denna symbolen ska kastas i enlighet med riktlinjerna (WEEE) för elektriska och elektroniska apparater på de lokala uppsamlingsställena för el- och elektroniksrot. Förbrukade batterier och akkumulatorer, som inte innesluts av aktuellt WEEE, t.ex. lampor, och som på ett icke-destruktivt sätt kan tas loss, ska innan WEEE lämnas till insamlingsstället separeras från den aktuellt WEEE. Distributörer är i enlighet med gällande lagstiftning skyldiga att ta hand om WEEE från slutanvändaren. Den gamla apparaten kan också skickas till följande adress för avfallshantering inom Tyskland: SLV GmbH, Technischer Service, Werkstrasse 8-10, 52531 Übach-Palenberg, Tyskland</p>
	<p>TR - Tasfiye açıklaması (Avrupa Birliği) Ürünü ev çöpiyle birlikte atmayın! Bu sembolü taşıyan ürünler, elektroteknik ve elektronik eski aletlerin yerel elektronik eski aletler toplama yerinde tasfiye edilmesi (WEEE) yönetmeliğine bağlıdır. Eski cihaz kapsamına girmeyen eski piller ve eski akümülatörler ve de eski cihazdan parçalanmadan çıkarılabilen lambalar, kayıt merkezine teslim edilmeden önce eski cihazdan parçalanmadan çıkarılmalıdır. Satıcılar ilgili yasal yükümlülükleri göre eski cihazları son kullanıcılardan geri almakla yükümlüdür. Eski cihaz Almanya içinde imha edilmek üzere aşağıdaki adrese de gönderilebilir: SLV GmbH, Technischer Service, Werkstrasse 8-10, 52531 Übach-Palenberg, Almanya</p>
	<p>HU - Hulladékkezelés (Európai Unió) A terméket ne a háztartási hulladékkal együtt dobja ki! A fenti jellel ellátott termékeket a WEEE, irányelv szerint az elektromos és elektronikus termékek számára kihelyezett hulladékgyűjtőkhöz tegye! Az olyan elemeket és akkumulátorokat, melyek nem zártan vannak a használt készülékbe helyezve valamint a használt készülékből roncsolás nélkül eltávolítható lámpákat a gyűjtőhelyen történő leadást megelőzően károsítás nélkül el kell távolítani. A forgalmazók a vonatkozó jogi előírásoknak megfelelően kötelesek visszavenni a végfelhasználótól a használt készülékeket. A régi készüléket a következő címre is elküldheti Németországon belüli ártalmatlanításra: SLV GmbH, Technischer Service, Werkstrasse 8-10, 52531 Übach-Palenberg, Németország</p>

	<p>DE - Entsorgung (Europäische Union)</p> <p>Produkt nicht im Hausmüll entsorgen! Produkte mit diesem Symbol sind entsprechend der Richtlinie(WEEE) über Elektro- und Elektronik-Altgeräte über die örtlichen Sammelstellen für Elektro-Altgeräte zu entsorgen! Altbatterien und Altakkumulatoren, die nicht vom Altgerät umschlossen sind, sowie Lampen, die zerstörungsfrei aus dem Altgerät entnommen werden können, sind vor der Abgabe an einer Erfassungsstelle vom Altgerät zerstörungsfrei zu trennen. Vertreiber sind, nach den jeweiligen gesetzlichen Verpflichtungen, verpflichtet Altgeräte von einem Endnutzer zurückzunehmen. Zur Entsorgung kann das Altgerät innerhalb Deutschlands auch an folgende Adresse versendet werden:</p> <p>SLV GmbH, Technischer Service, Werkstrasse 8-10, 52531 Übach-Palenberg</p>
	<p>EN - Disposal (European Union)</p> <p>Do not dispose the product with the regular household waste! Products marked with this sign must be disposed according to the directive (WEEE) on electrical and electronic devices at local collection points for such devices! Waste batteries and accumulators, which are not enclosed by the waste equipment, and lamps, which are removable non-destructively from the waste equipment are to be separated non-destructively from the waste equipment before turning to a local collection point.</p> <p>Distributors are, according to particular legislation, obligated to take back waste equipment from the final holder. For disposal within Germany the waste equipment may be send to the following address:</p> <p>SLV GmbH, Technischer Service, Werkstrasse 8-10, 52531 Übach-Palenberg, Germany</p>
	<p>FR - Information de recyclage (Union européenne)</p> <p>Ne recyclez pas le produit avec les ordures ménagères ! Les produits qui présentent ce symbole sont à recycler suivant la directive (WEEE) relative aux déchets d'équipements électriques et électroniques, via des points de collecte pour appareils électriques usagés ! Les piles et accus usagés qui ne sont pas incorporés dans l'appareil usagé, ainsi que les lampes qui peuvent être retirées de l'appareil usagé sans être détruites, doivent être retirés de l'appareil usagé sans être détruits avant d'être remis au Recyparc. Conformément à leurs obligations légales respectives, les distributeurs sont tenus de reprendre les appareils usagés d'un utilisateur final.</p> <div data-bbox="155 597 944 731">  <p>Points de collecte sur www.quefairedemesdechets.fr Privilégiez la réparation ou le don de votre appareil !</p> <p>Points de collecte sur www.quefairedemesdechets.fr</p> </div> <p>Pour l'élimination, l'appareil usagé peut également être envoyé en Allemagne à l'adresse suivante :</p> <p>SLV GmbH, Technischer Service, Werkstrasse 8-10, 52531 Übach-Palenberg, Allemagne</p>
	<p>ES - Indicaciones para la eliminación (Unión Europea)</p> <p>¡No tirar el producto con la basura doméstica! Los productos con este símbolo deben eliminarse, de acuerdo con la directiva (WEEE) sobre residuos de aparatos eléctricos y electrónicos, llevándolos a los puntos de recogida selectiva de aparatos eléctricos y electrónicos locales. Las baterías y los acumuladores recargables que no se hallen protegidos por el aparato viejo, así como las lámparas, extraídas sin romperlas del aparato viejo, deben desmontarse sin llegar a alterarlos antes de entregarlos a un punto de recogida.</p> <p>Los distribuidores están obligados a recoger los aparatos viejos de un usuario final según las obligaciones legales pertinentes. El aparato antiguo también puede enviarse a la siguiente dirección para su eliminación dentro de Alemania:</p> <p>SLV GmbH, Technischer Service, Werkstrasse 8-10, 52531 Übach-Palenberg, Alemania</p>
	<p>IT - Istruzioni per lo smaltimento (Unione Europea)</p> <p>Non smaltire il prodotto con i rifiuti domestici! I prodotti con questo simbolo devono essere smaltiti, nel rispetto della Direttiva (WEEE) sui rifiuti di apparecchiature elettriche ed elettroniche, nei punti di raccolta locale ad essi adibiti! Verificare sul sito www.slvitalia.it il corretto metodo di smaltimento del presente materiale. Le batterie e gli accumulatori usati non racchiusi nell'apparecchio usato e le lampade rimovibili dall'apparecchio usato senza venire distrutte, devono essere divise dall'apparecchio usato senza venire distrutte, prima di essere consegnate in un punto di raccolta. I rivenditori sono tenuti, secondo i rispettivi obblighi legali, a ritirare gli apparecchi usati dal consumatore finale. Il vecchio apparecchio può anche essere inviato al seguente indirizzo per lo smaltimento in Germania:</p> <p>SLV GmbH, Technischer Service, Werkstrasse 8-10, 52531 Übach-Palenberg, Germania</p>
	<p>NL - Afvalverwijdering (Europese Unie)</p> <p>Het product niet via het huishoudelijk afval weggooien! Producten met dit symbool dienen in overeenstemming met richtlijn (WEEE) via elektrische en elektronische apparatuur bij de plaatselijke inzamelpunten voor elektrisch afval te worden verwijderd! Afgedankte accu's en accumulators die niet in het afgedankte apparaat zijn ingebouwd, zoals lampen die zonder beschadigingen uit het apparaat kunnen worden verwijderd, dienen voorafgaand aan de afgifte aan de betreffende instantie voor afgedankt apparaatuur, niet-destructief verwijderd te worden. De verkopers zijn op basis van de betreffende wettelijke regelgeving, verplicht afgedankte apparaten van een eindgebruiker terug te nemen. Het oude apparaat kan ook naar het volgende adres worden gestuurd voor verwijdering binnen Duitsland:</p> <p>SLV GmbH, Technischer Service, Werkstrasse 8-10, 52531 Übach-Palenberg, Duitsland</p>

Installation Steps

A Embedded installation

1. Remove the ceiling drywall

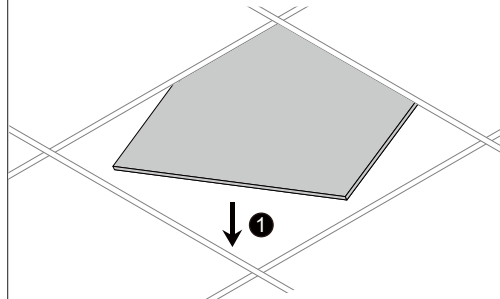

2. Place the luminaire on the keel frame

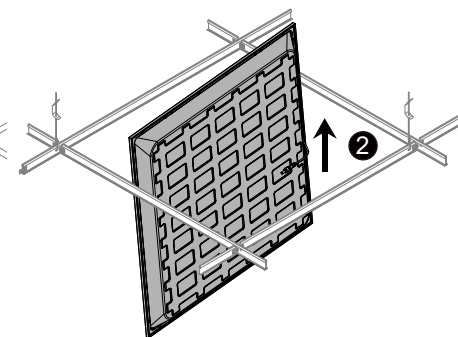

3. Connecting Driver

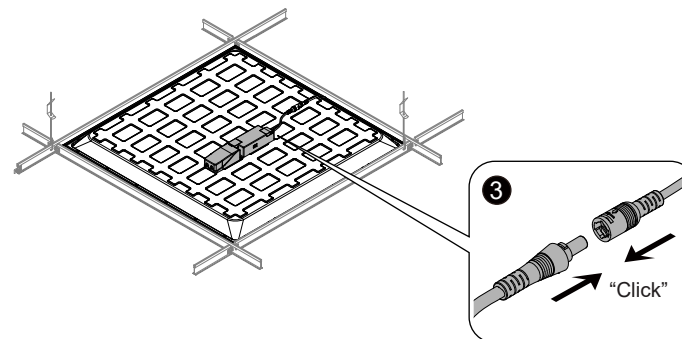

4. Connecting Power Supply

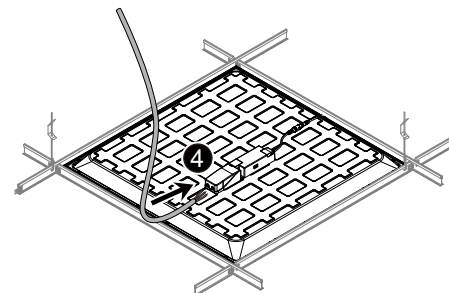

Installation Steps

B Installation of retaining spring

1. Drill holes in the ceiling according to the size of the luminaire

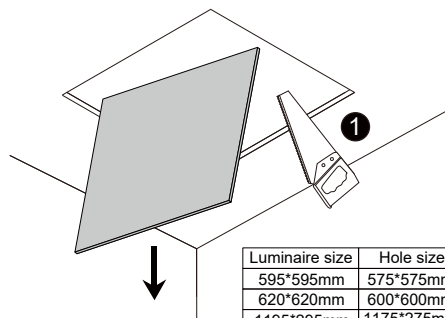

Luminaire size	Hole size
595*595mm	575*575mm
620*620mm	600*600mm
1195*295mm	1175*275mm
1195*595mm	1175*575mm

2. Fix the retaining spring to the luminaire with screws

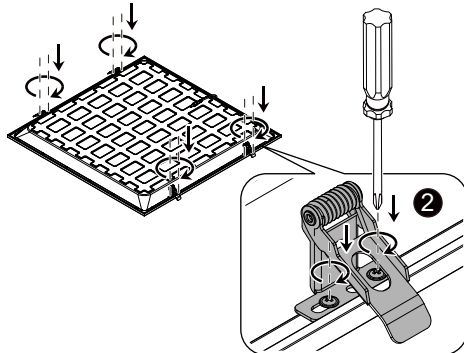

3. Connecting Driver

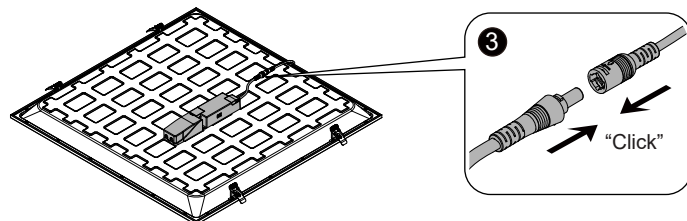

4. Connecting Power Supply

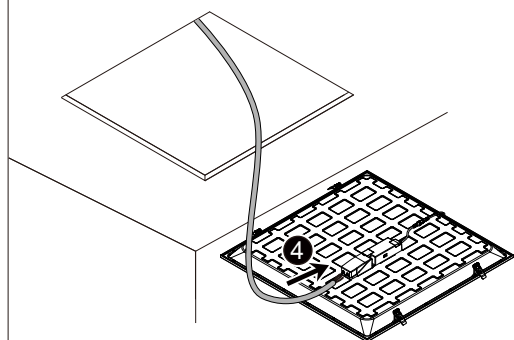

5. Straighten the retaining spring and fasten the lamp into the ceiling

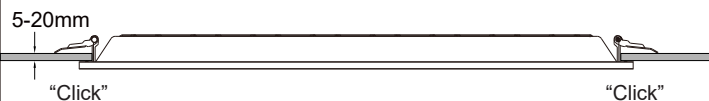
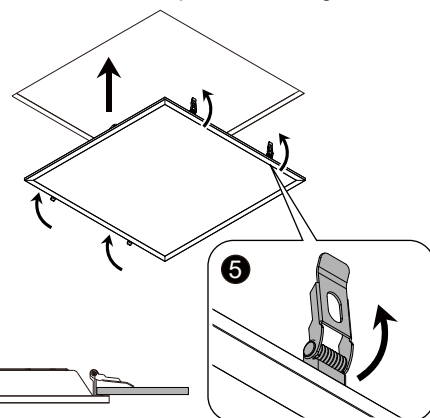

Connecting Power Supply

B DALI

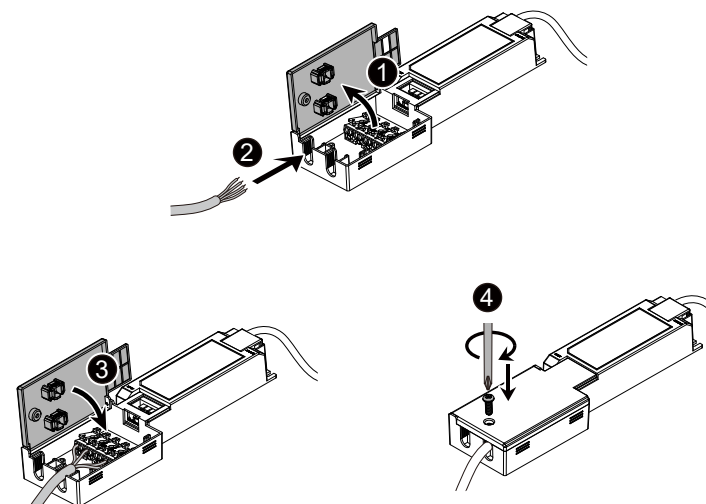

4 Wires specification:

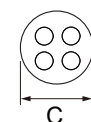

Outer diameter: $\varnothing 8\text{mm} \leq C \leq 10\text{mm}$

Core of cable: $4 \times 0.75 \sim 1.5\text{mm}^2$

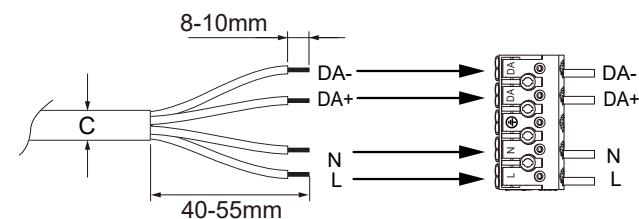

Connecting Power Supply

A ON / OFF

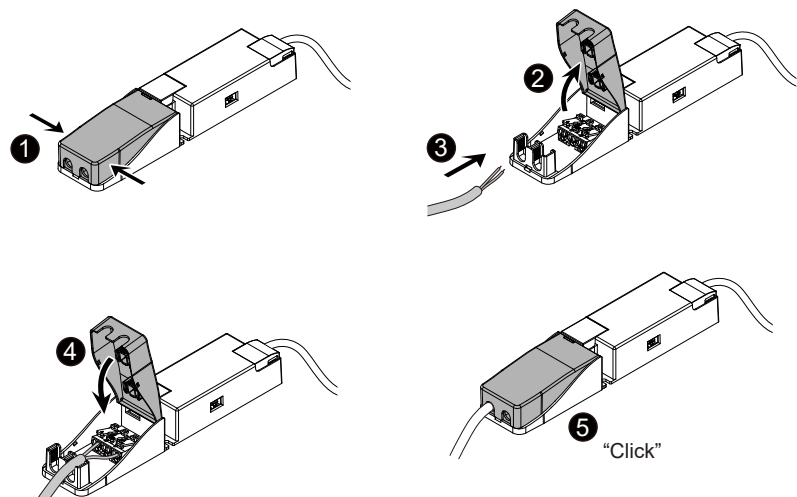

2 Wires specification:



Outer diameter: $\varnothing 8\text{mm} \leq C \leq 10\text{mm}$
Core of cable: $2 \times 0.75 \sim 2.5\text{mm}^2$

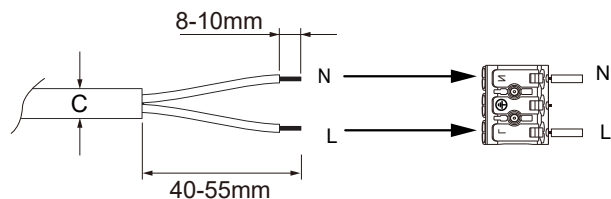

Installation Steps

C Suspended mounted

1. Measure the distance and drill holes to suspend the steel cable suspension kits

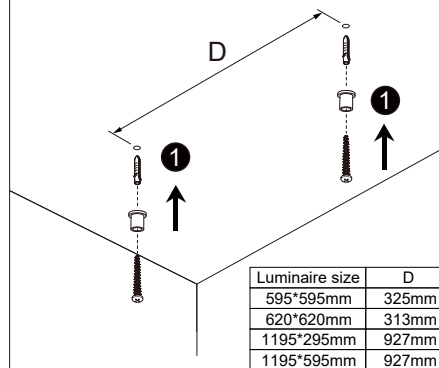

2. Fix the triangular lifting lugs to the luminaire with screws

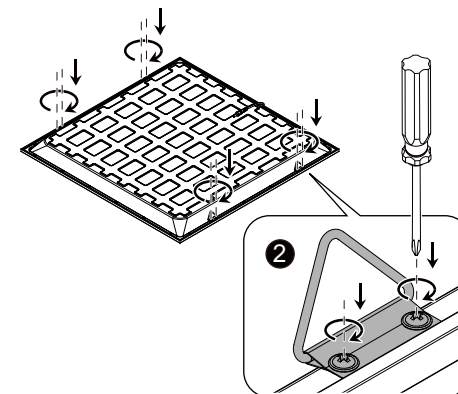

3. Clamp the steel cable onto the triangular lifting lugs

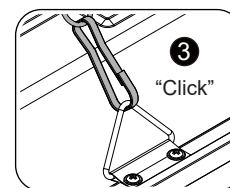

4. Fix the steel cable kit to the ceiling

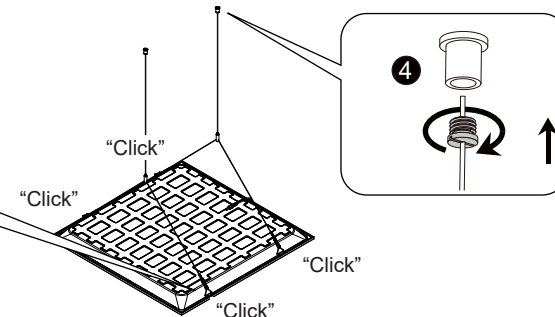

5. Connecting Driver

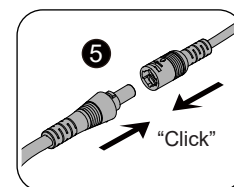

6. Connecting Power Supply

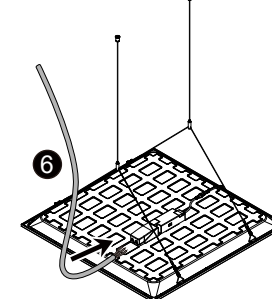

Wattage setting

A ON / OFF

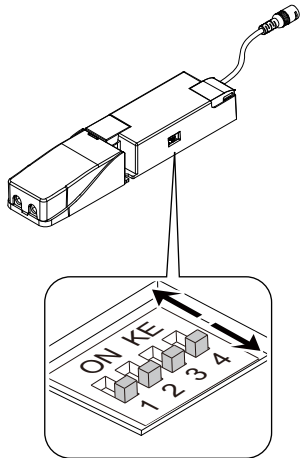

Output current [mA]	Switch position (ON/OFF)				Power [W]	1010109, 1010566 1010747, 1010751		1010110, 1010567 1010748, 1010752	
						4000K		3000K	
	1	2	3	4		Light effect [lm/W]	Flux [lm]	Light effect [lm/W]	Flux [lm]
500	OFF	OFF	OFF	OFF	21	182.7	3838	173.6	3646
550	ON	OFF	OFF	OFF	23	182.1	4189	173.0	3979
600	OFF	ON	OFF	OFF	25	181.4	4535	172.3	4308
650	OFF	OFF	ON	OFF	27	180.7	4878	171.6	4634
700	ON	OFF	ON	OFF	29	179.7	5211	170.7	4950
750	OFF	ON	ON	OFF	31	178.7	5541	169.8	5264
800	OFF	OFF	OFF	ON	33	177.7	5864	168.8	5571
850	ON	OFF	OFF	ON	35	176.7	6186	167.9	5876
900	OFF	ON	OFF	ON	38	175.7	6677	166.9	6343
950	OFF	OFF	ON	ON	40	174.5	6981	165.8	6632
1000	ON	OFF	ON	ON	42	173.5	7285	164.8	6921

Output current [mA]	Switch position (ON/OFF)				Power [W]	1010113, 1010570		1010114, 1010571	
						4000K		3000K	
	1	2	3	4		Light effect [lm/W]	Flux [lm]	Light effect [lm/W]	Flux [lm]
500	OFF	OFF	OFF	OFF	21	178.7	3752	169.7	3564
550	ON	OFF	OFF	OFF	23	178.0	4093	169.1	3888
600	OFF	ON	OFF	OFF	25	177.0	4425	168.1	4203
650	OFF	OFF	ON	OFF	27	176.2	4756	167.3	4518
700	ON	OFF	ON	OFF	29	175.4	5088	166.7	4833
750	OFF	ON	ON	OFF	31	174.4	5407	165.7	5137
800	OFF	OFF	OFF	ON	33	173.8	5734	165.1	5447
850	ON	OFF	OFF	ON	35	172.6	6042	164.0	5740
900	OFF	ON	OFF	ON	38	171.6	6522	163.0	6195
950	OFF	OFF	ON	ON	40	170.5	6820	162.0	6479
1000	ON	OFF	ON	ON	42	169.5	7117	161.0	6761

Output current [mA]	Switch position (ON/OFF)				Power [W]	1010117, 1010574		1010118, 1010575	
	1	2	3	4		4000K		3000K	
						Light effect [lm/W]	Flux [lm]	Light effect [lm/W]	Flux [lm]
500	OFF	OFF	OFF	OFF	21	185.3	3891	176.0	3696
550	ON	OFF	OFF	OFF	23	184.8	4250	175.5	4037
600	OFF	ON	OFF	OFF	25	185.2	4629	175.9	4398
650	OFF	OFF	ON	OFF	27	184.5	4981	175.2	4732
700	ON	OFF	ON	OFF	29	183.9	5334	174.7	5067
750	OFF	ON	ON	OFF	31	183.3	5681	174.1	5397
800	OFF	OFF	OFF	ON	33	182.5	6023	173.4	5722
850	ON	OFF	OFF	ON	35	182.1	6375	173.0	6056
900	OFF	ON	OFF	ON	37	181.5	6715	172.4	6379
950	OFF	OFF	ON	ON	39	180.7	7048	171.7	6696
1000	ON	OFF	ON	ON	41	179.8	7370	170.8	7001

Wattage setting

B DALI

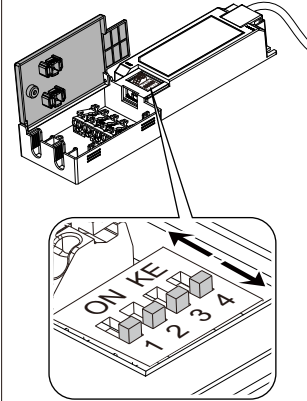

Output current [mA]	Switch position (ON/OFF)				Power [W]	1010111, 1010568 1010749, 1010753		1010112, 1010569 1010750, 1010754	
						4000K		3000K	
	1	2	3	4		Light effect [lm/W]	Flux [lm]	Light effect [lm/W]	Flux [lm]
600	OFF	ON	ON	ON	26	169.2	4399	160.7	4179
650	ON	OFF	ON	ON	28	169.2	4737	160.7	4500
700	OFF	OFF	ON	ON	30	169.2	5076	160.7	4822
750	OFF	ON	OFF	ON	33	168.6	5565	160.2	5287
800	OFF	OFF	OFF	ON	35	168.3	5890	159.9	5595
850	ON	ON	ON	OFF	37	167.5	6197	159.1	5887
900	OFF	OFF	ON	OFF	39	166.7	6502	158.4	6177
950	OFF	ON	OFF	OFF	41	166.0	6804	157.7	6464

Output current [mA]	Switch position (ON/OFF)				Power [W]	1010115, 1010572		1010116, 1010573	
						4000K		3000K	
	1	2	3	4		Light effect [lm/W]	Flux [lm]	Light effect [lm/W]	Flux [lm]
600	OFF	ON	ON	ON	26	166.5	4329	158.2	4112
650	ON	OFF	ON	ON	28	166.0	4649	157.7	4416
700	OFF	OFF	ON	ON	30	165.9	4977	157.6	4728
750	OFF	ON	OFF	ON	33	165.5	5462	157.2	5189
800	OFF	OFF	OFF	ON	35	165.1	5780	156.9	5491
850	ON	ON	ON	OFF	37	164.4	6083	156.2	5779
900	OFF	OFF	ON	OFF	39	163.8	6390	155.6	6070
950	OFF	ON	OFF	OFF	41	163.0	6684	154.9	6350

Output current [mA]	Switch position (ON/OFF)				Power [W]	1010119, 1010576		1010120, 1010577	
	1	2	3	4		4000K		3000K	
						Light effect [lm/W]	Flux [lm]	Light effect [lm/W]	Flux [lm]
600	OFF	ON	ON	ON	26	173.8	4518	165.1	4292
650	ON	OFF	ON	ON	28	173.9	4868	165.2	4625
700	OFF	OFF	ON	ON	30	173.9	5218	165.2	4957
750	OFF	ON	OFF	ON	32	173.8	5561	165.1	5283
800	OFF	OFF	OFF	ON	34	173.4	5896	164.7	5601
850	ON	ON	ON	OFF	36	173.2	6236	164.5	5924
900	OFF	OFF	ON	OFF	38	172.9	6571	164.3	6242
950	OFF	ON	OFF	OFF	41	172.3	7064	163.7	6711