

## Installation Steps

### 6-a Connecting Power Supply ON / OFF

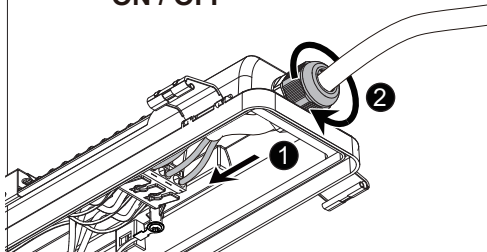

#### 3 Wires specification:

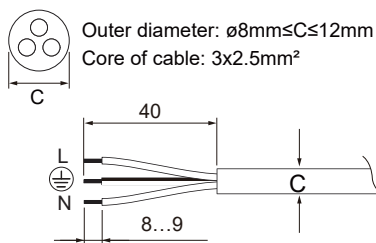

### 6-b Connecting Power Supply DALI

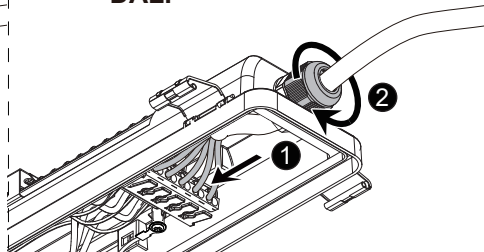

#### 5 Wires specification:

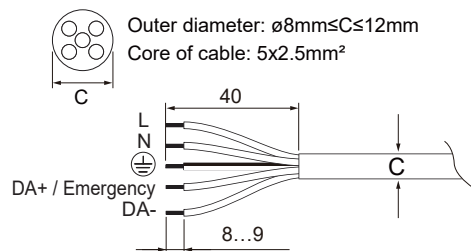

### 7 Close the lid and fasten the buckles

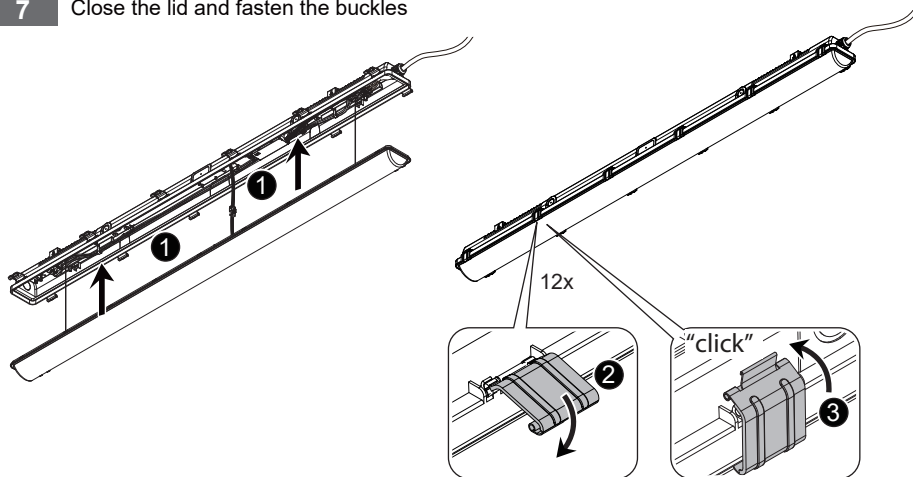

# Waterproof C Installation Manual



## IMPORTANT SAFETY NOTES



### WARNING

RISK OF ELECTRIC SHOCK

#### BEFORE YOU BEGIN

- Read these instructions completely and carefully.
- The installation and connection of the luminaire must be done when switched off and by qualified people. Make sure no voltage while installation.



### CAUTION

#### MAINTENANCE

- To avoid injuries, disconnect power to the light and allow the unit to cool down before performing maintenance.
- Perform visual, mechanical and electrical inspections on a regular basis. We recommend routine checks to be made on an annual basis. Frequency of use and environment should determine this.
- The Covers should be cleaned periodically as needed to ensure continued photometric performance. Clean the Cover with a damp, non-abrasive, lintfree cloth. If not sufficient, use mild soap or a liquid cleaner. Do not use an abrasive, strong alkaline or acid cleaner as damage may occur.
- Inspect the topside on the luminaire to ensure that it is free of any obstructions or contamination (i.e. excessive dust build-up). Clean with a non-abrasive cloth if needed.



This product contains a light source of energy efficiency class D.

## Products

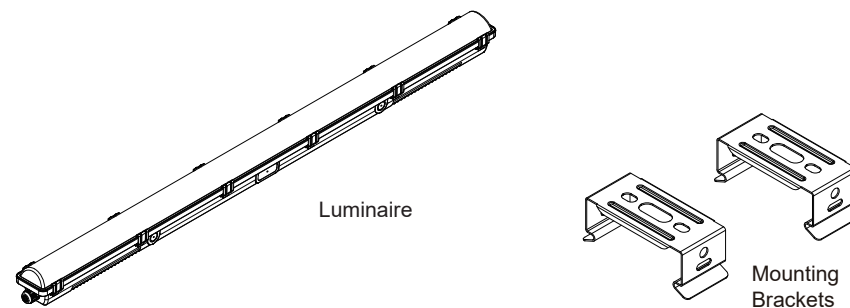

## Dimensions

[ mm ]

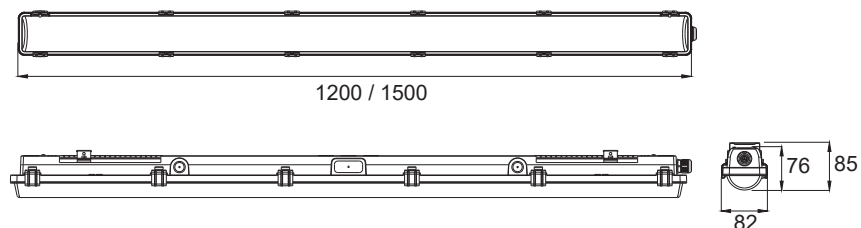

## Installation Steps

- 1** Drill holes and secure the mounting brackets

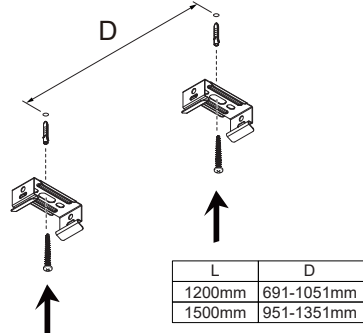

- 2** Unbuckle

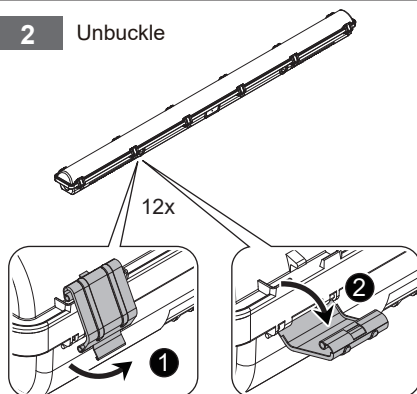

- 3** Wattage & CCT Setting

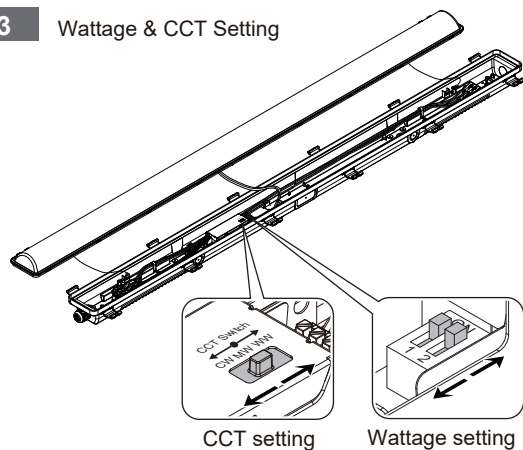

| mA  | 1   | 2   | Power(W) |        |
|-----|-----|-----|----------|--------|
|     |     |     | 1200mm   | 1500mm |
| 200 | OFF | OFF | 21       | 26.5   |
| 250 | OFF | ON  | 27       | 33     |
| 300 | ON  | OFF | 32       | 40     |
| 350 | ON  | ON  | 38       | 47     |

CCT setting

Wattage setting

## Installation Steps

- 4** Fix the luminaire on the mounting brackets

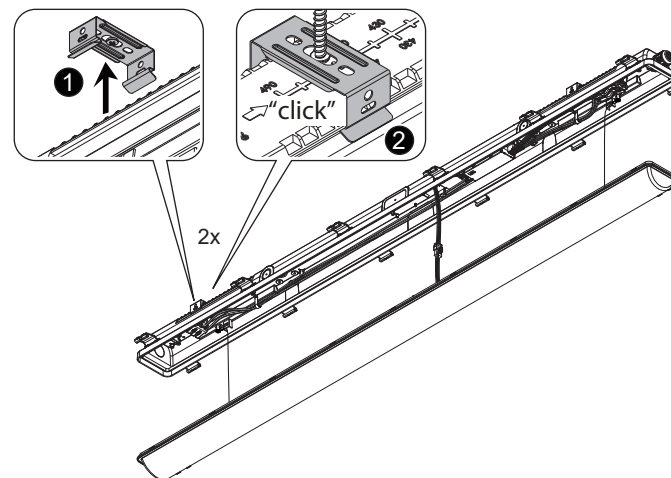

- 5** Thread the AC wire through the waterproof connector

