

Installation Steps

6-a Connecting Power Supply ON / OFF

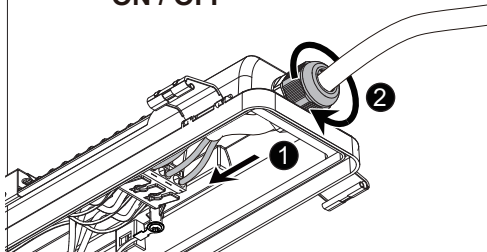

3 Wires specification:

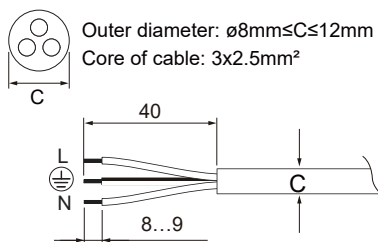

6-b Connecting Power Supply DALI

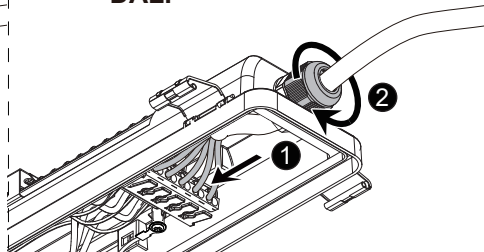

5 Wires specification:

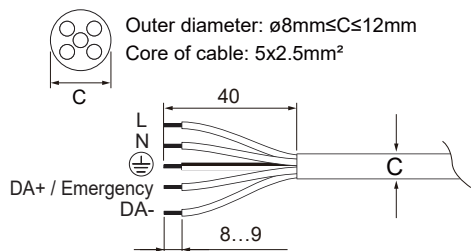

7 Close the lid and fasten the buckles

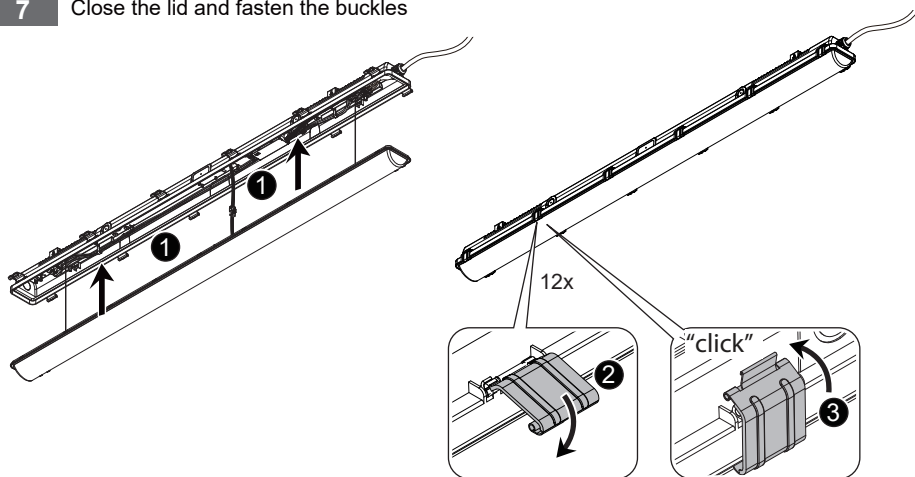

Waterproof P Installation Manual



IMPORTANT SAFETY NOTES



WARNING

RISK OF ELECTRIC SHOCK

BEFORE YOU BEGIN

- Read these instructions completely and carefully.
- The installation and connection of the luminaire must be done when switched off and by qualified people. Make sure no voltage while installation.



CAUTION

MAINTENANCE

- To avoid injuries, disconnect power to the light and allow the unit to cool down before performing maintenance.
- Perform visual, mechanical and electrical inspections on a regular basis. We recommend routine checks to be made on an annual basis. Frequency of use and environment should determine this.
- The Covers should be cleaned periodically as needed to ensure continued photometric performance. Clean the Cover with a damp, non-abrasive, lintfree cloth. If not sufficient, use mild soap or a liquid cleaner. Do not use an abrasive, strong alkaline or acid cleaner as damage may occur.
- Inspect the topside on the luminaire to ensure that it is free of any obstructions or contamination (i.e. excessive dust build-up). Clean with a non-abrasive cloth if needed.



This product contains a light source of energy efficiency class C.

Products

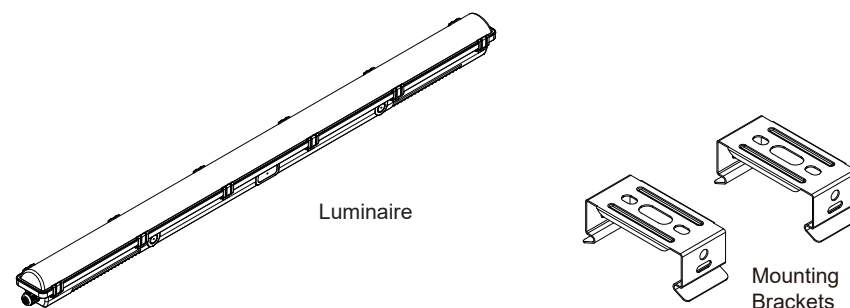

Dimensions

[mm]

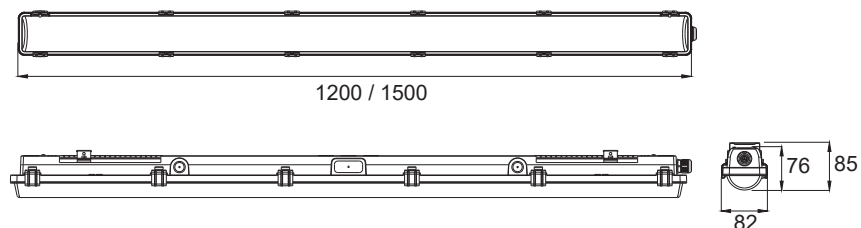

Installation Steps

- 1** Drill holes and secure the mounting brackets

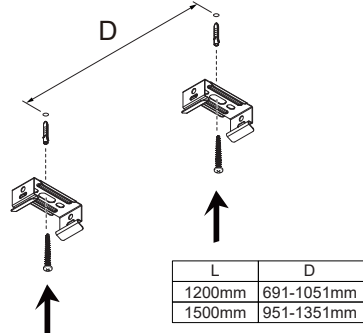

- 2** Unbuckle

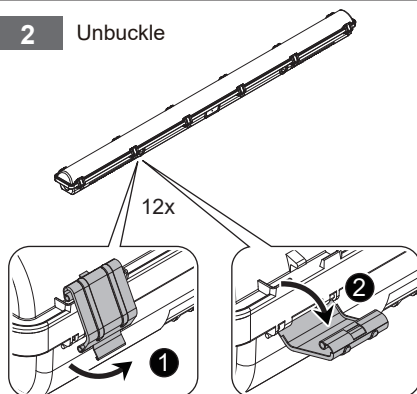

- 3** Wattage & CCT Setting

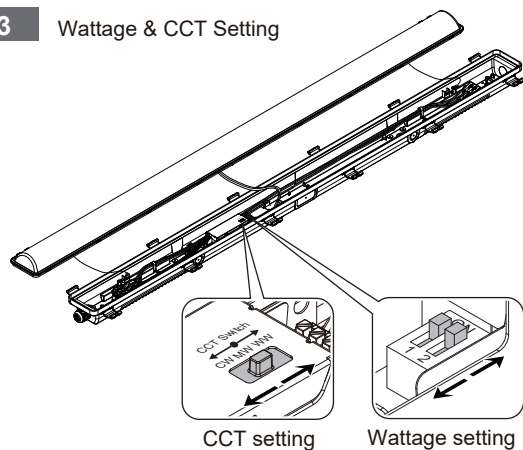

mA	1	2	Power(W)	
			1200mm	1500mm
200	OFF	OFF	21	26.5
250	OFF	ON	27	33
300	ON	OFF	32	40
350	ON	ON	38	47

CCT setting

Wattage setting

Installation Steps

- 4** Fix the luminaire on the mounting brackets

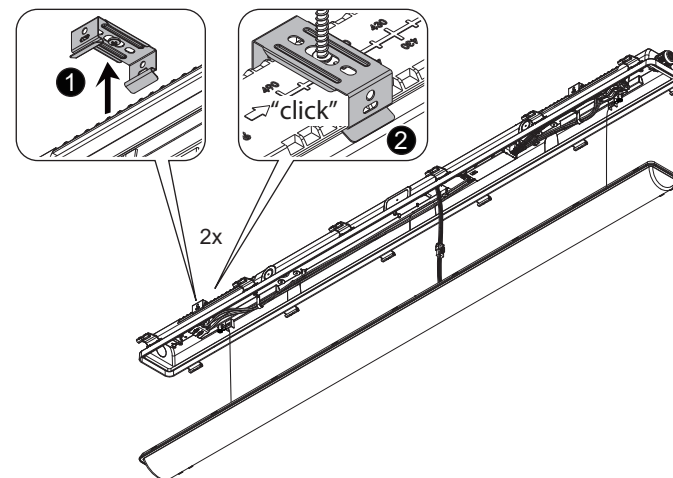

- 5** Thread the AC wire through the waterproof connector

